

TAIPEI MUSIC CENTER

台北流行音樂中心

Concert Hall Technical Specification



Table of Contents

General Information		02	
Taipei Music Center	02	Backstage Access	07
Concert Hall	04	Load in / Load Out	08
Visiting Taipei Music Center	06	Concert Hall Capacity	10
Stage		13	
Main Stage	14	Sound Insulation Wall	15
Stage Curtains	15	Elevator Platform	16
Rigging		19	
Main Stage – Mother Truss Grids	20	Ground Floor – Existing & Additional Rigging Points	22
Audio		25	
Audio Equipment List	26	Sound System Floorplan	30
Sound Pressure Data	27		
Lighting		33	
Lighting Equipment List	34	Follow Spot Floorplan	36
Lighting System Floorplan	35		

Broadcasting Hub Network				37
LEMO Video Monitoring	38	Other Hub Network Systems	41	
Broadcasting System		Optical Fiber & Camera BNC	41	
LEMO Panel Number &	38	Panel Number & Location		
Location		Optical Fiber & Camera BNC	43	
LEMO Panel Configuration	39	Panel Configuration		
Power				45
Switchboard Number &	46	Switchboard Configuration	48	
Location				
Backstage & Dressing Rooms				51
Backstage & Dressing Rooms	52	Backstage Inventory	56	
Facilities				
Appendix				57
Appendix I Full Floorplan	58	Appendix IV Stage Side View	61	
Appendix II Stage Floorplan	59	Floorplan		
Appendix III Stage Elevation	60	Appendix V Rigging Points	62	
Floorplan		Floorplan		
		Appendix VI Lighting Floorplan	63	



Taipei Music Center —Heart of Pop Music

Taipei Music Center, is a modern musical venue comprising three integrated buildings along the Civic Boulevard. Located in between Nangang and Kungyang MRT station. The Concert Hall is a medium size performing venue exclusive for pop music performances offering seating for 5,000 people in the North base. In addition, the Music Cultural Center and Music Industry Center of Taipei Music Center in the South base are designed to document the history of Taiwan pop music artists, as well as giving opportunities in fostering talent artists.

Taipei Music Center is not only a music performing venue. More over it is a multi-culture platform for traditional and pop music. The buildings were built by the RUR Architecture from USA, designs were inspired by the Roman Forum, creating a multifunction arena for performances, activities and holiday markets.





Concert Hall

The Concert Hall is also known as the “Spacecraft”. The outline of the building corresponds to the beautiful mountains in Taiwan, as well as to symbolize the rise of Taiwan pop music. The Concert Hall is designed exclusive for pop music performances. The building has five stories above and three stories below ground. With a capacity of 5,000 seating, including dressing rooms, lounges, rehearsal rooms, administration office and information center.



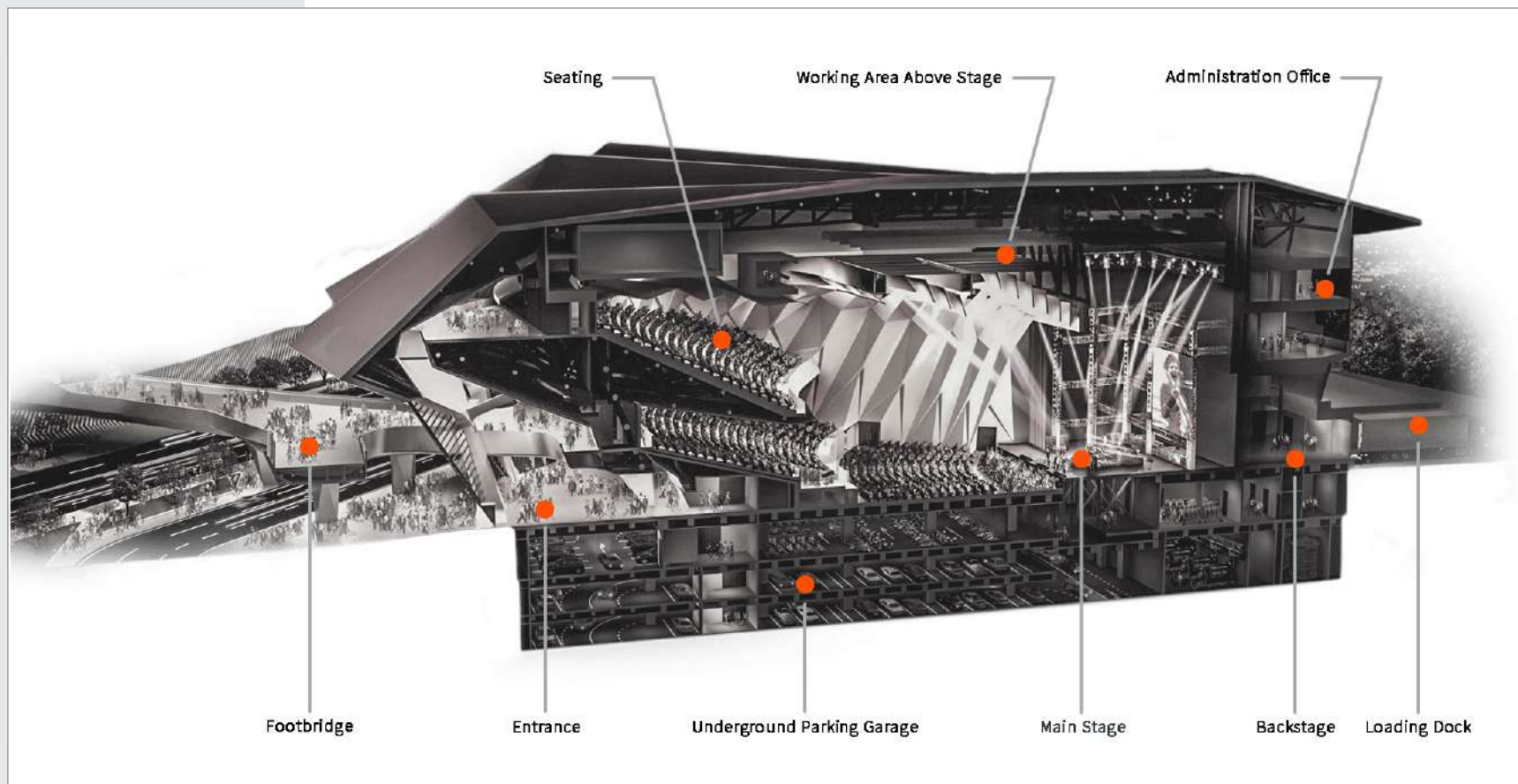



Visiting Taipei Music Center

Taipei Music Center

Address: No. 99, Sec. 8, Civic Blvd., Nangang Dist., Taipei City 115, Taiwan

Public Transportation

- Taipei Metro: 8 minute walk from Kungyang station, exit no. 4 (MRT Bannan line).
- High Speed Rail and Train: 11 minute walk from north exit of Nangang train station.
- Bus: 1 minute walk from Dongming Li bus station.

► Map of the Concert Hall

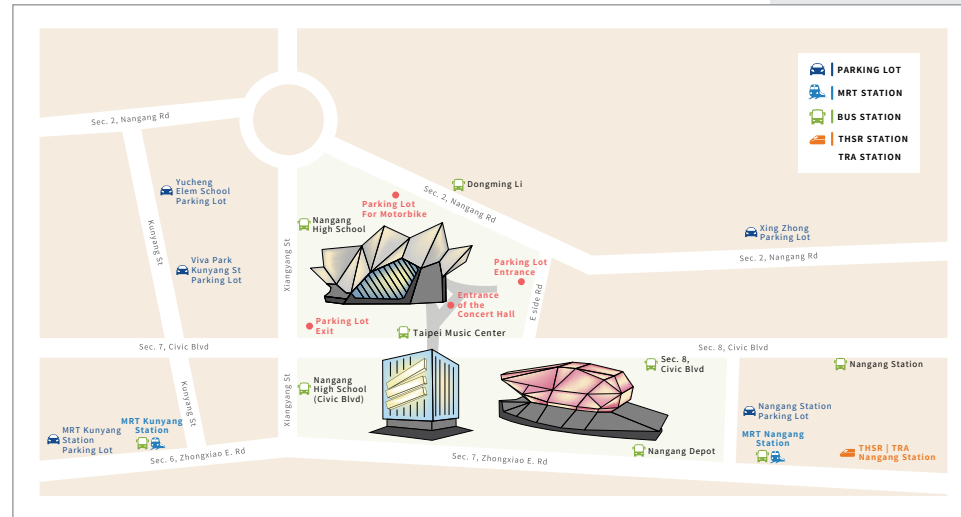

Parking

Car Parking

Access from east lane on section 2 Nangang road. Parking is located in B1-B3 with a height limit of 2.1m. Comprising a total of 293 car spaces including 6 accessible parking spaces and 6 parents & kid parking spaces.

Car Parking Rate

- Non event days: NT\$30/per hour

Minimum parking rate is one hour. An additional NT\$15 will be charged for each 30 minutes.

- Event days: NT\$60/per hour

Minimum parking rate is one hour. An additional NT\$30 will be charged for each 30 minutes.

Motorcycle Parking

Access from Section 2, Nangang Road.

Total of 583 motorcycle parking spaces (including 12 accessible parking bays).

Motorcycle Parking Rate

- Non event days: NT\$20 flat rate per day

- Event days: NT\$50 flat rate per day

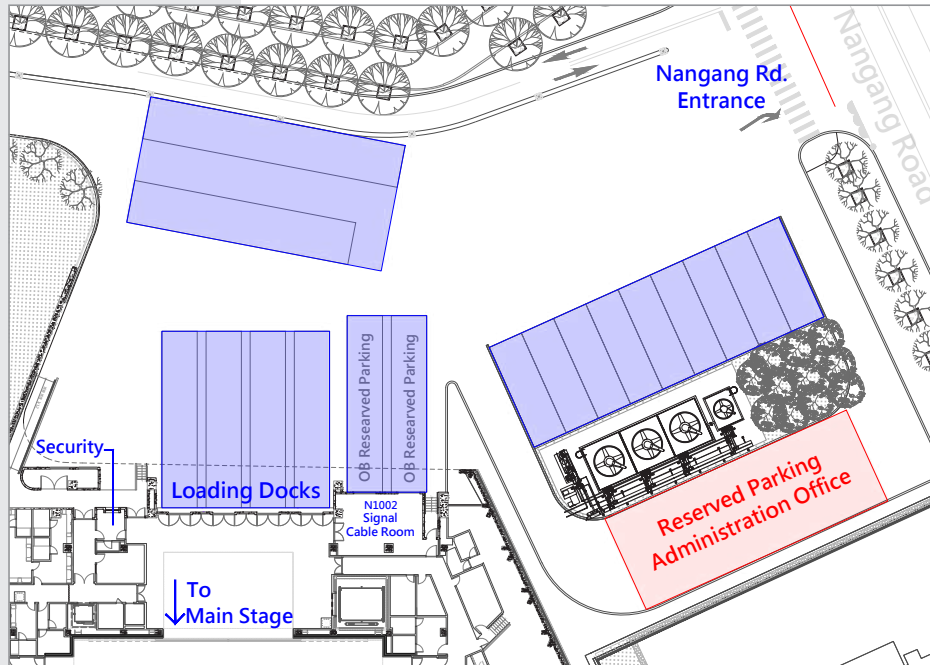

▲ Outdoor parking spaces for organizers

Backstage Access

Access from loading dock on section 2 Nangang road, next to Bank of Taiwan.

Backstage and Parking Access

All crew member should wear backstage pass at all times while working in the venue. Organizers shall submit backstage pass application form in advance. Backstage pass is required upon entering the venue.

- Load in & out: permits are required upon entering the venue. Permit application form should submit in advance including license plate number to the security prior upon arrival.
- Rehearsal and event days: permits are required upon entering the venue. Permit application form including license plate number should submit to the security prior upon arrival.

Parking Information

- Loading Dock
Reserved for working crews vehicles, including Artists vans, SNG vehicles, 3.5-ton trucks, cargo trucks and fork lifts. Excluding reserved parking spaces of the venue, organizer can arrange the loading dock upon request.



Load In / Load Out

Loading Dock

4 loading docks accommodating for 4 vehicles to load in and out at the same time.

Loading dock dimension: 245cm wide and 264cm high. Loading platform is 85cm from ground.

Indoor Backstage Loading Dock

Indoor backstage loading dock dimension: 20.7m wide and 12.55m deep. Minimum height is 4.12m and maximum height is 10m.

Cargo Lift

Cargo lift elevator dimension: 2.5m door wide, 3m high and 4.8m deep. Elevator is 3.6m wide internally.

Side Entrance

Aside from main loading dock, you may also unload from the side entrance which is 2.12m wide and 2.37m high.

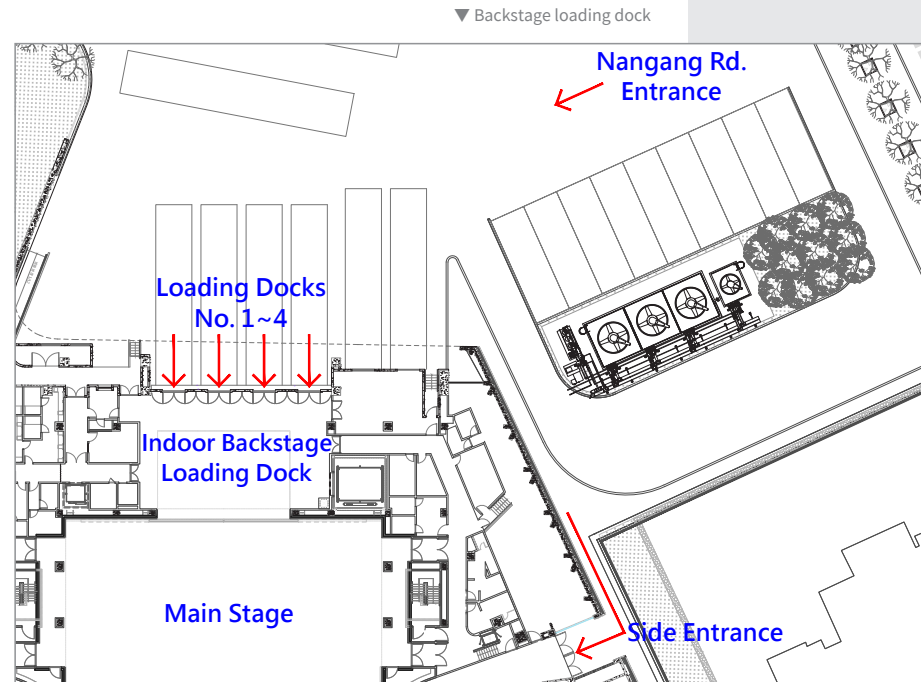

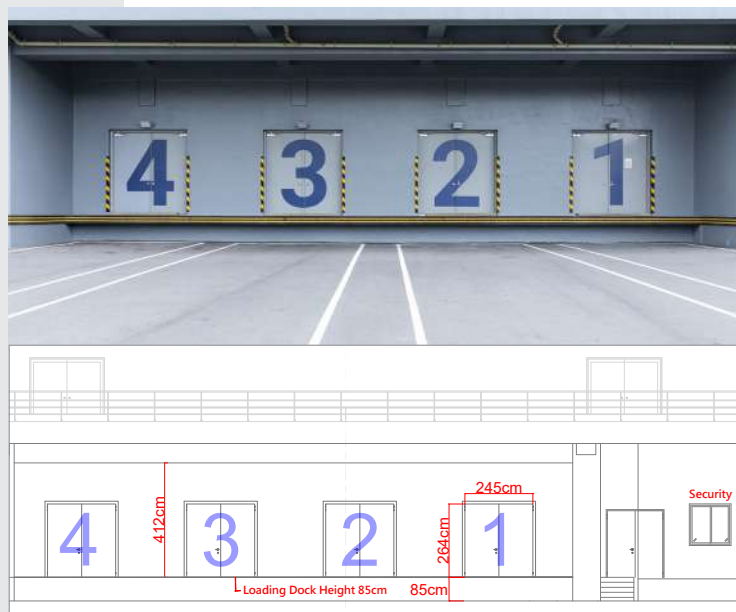

▲ Loading docks No.1~4

▲ Loading dock dimension ▼ Indoor backstage loading dock

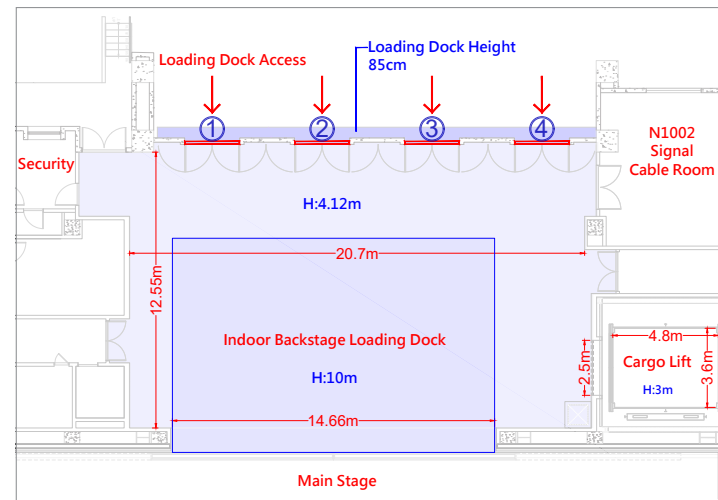
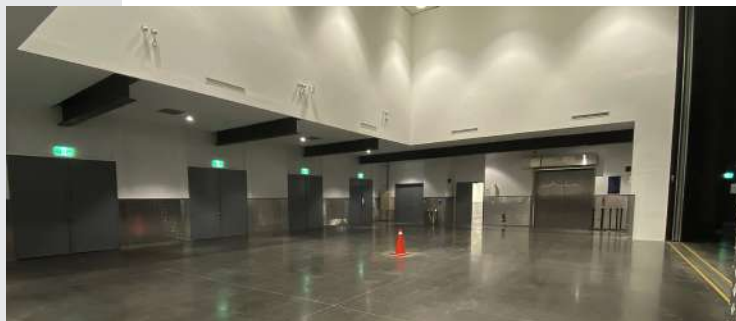

▲ Indoor backstage loading dock dimension ▼ Side entrance





Concert Hall Capacity

Floor \ No. of Seats	Audience Seats	Accessible Seats	Accompanying Seats	Staff Reserved
1F	No fixed seats are set, organizers can make their own arrangement as long as venue regulations are followed.			
2F	1463	21	22	4
3M & 3F	1671	-	-	6

Instructions for 1F Seating

Auditorium’s audience seating on the first floor can be planned according to organizer’s requirements; however it requires to fulfill fire & safety regulations, and evacuation guidelines as follow.

- Vertical aisle should be at least 4.5m wide in total.
- From the left to right, walkways should be at least 1.5m wide.
- Distance from front of stage to first row seating should be at 3m.
- Last row seating should be at least 1m away from the back wall.
- All production equipment including front of house, extension platforms, camera platforms, and hardware etc. should be a meter away from the audience.

▼ Clearance access example for 1F seating

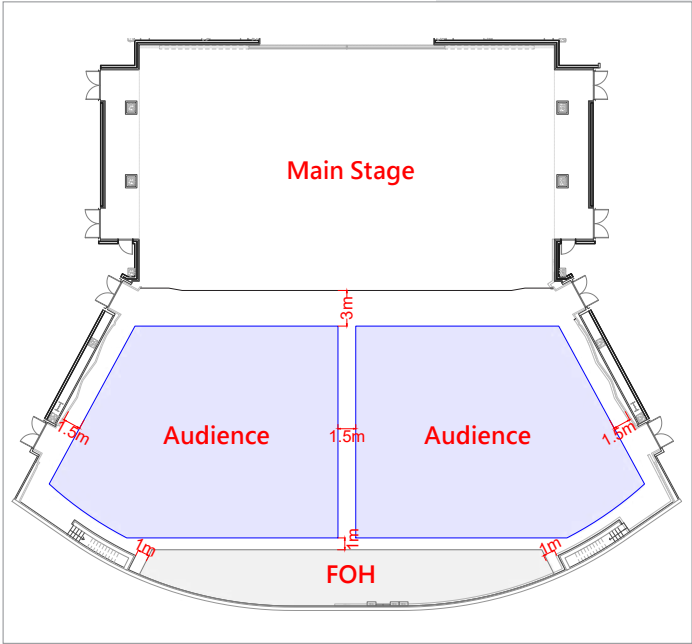

▼ 1F seating arrangement example

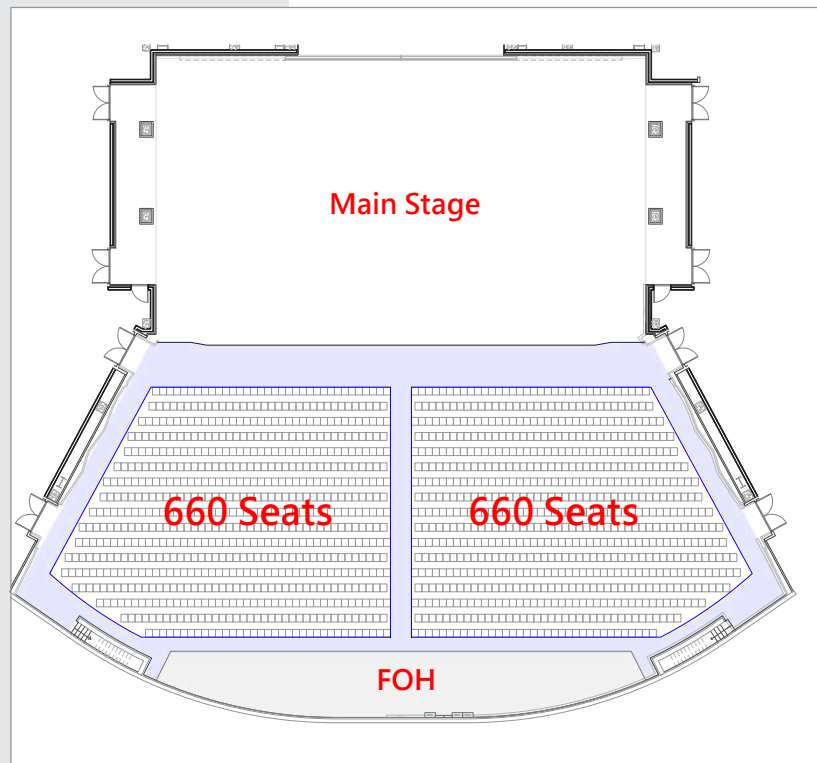

▼ 1F standing capacity example

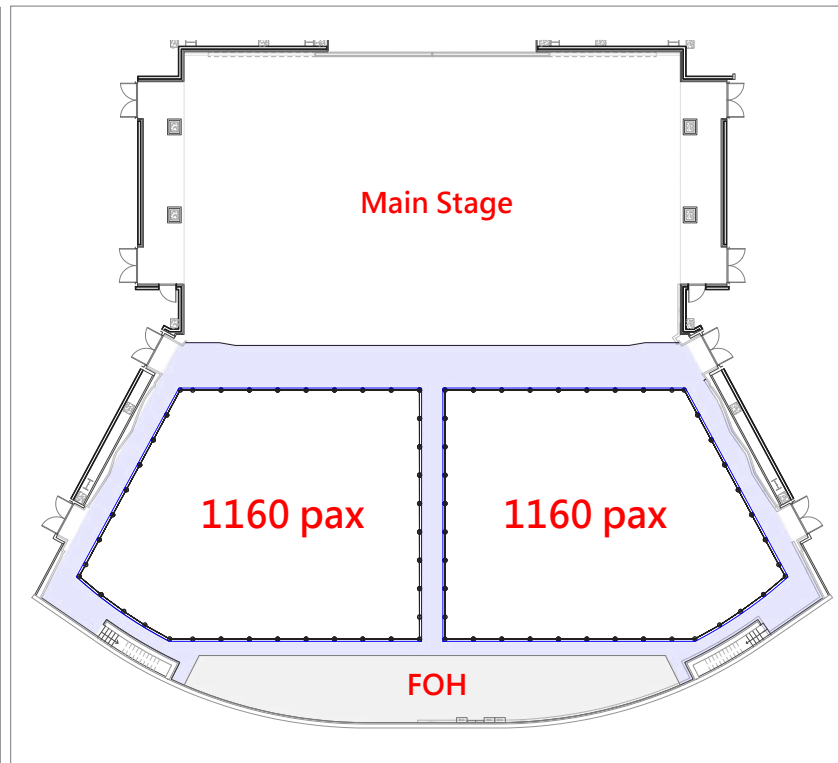



▼ 2F seating

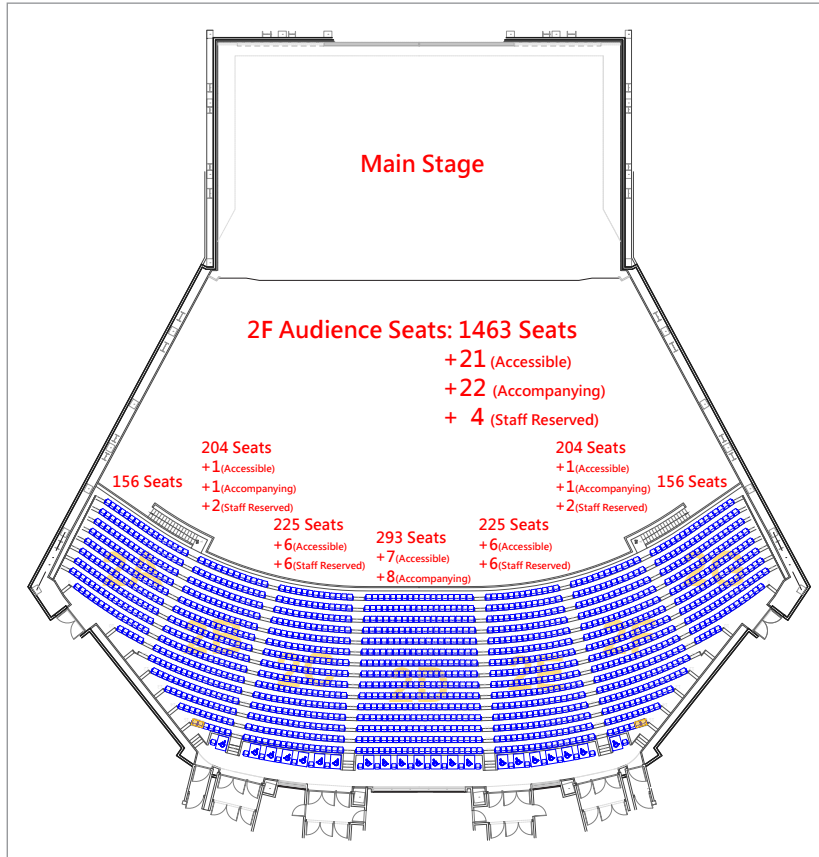

▼ 3M & 3F seating

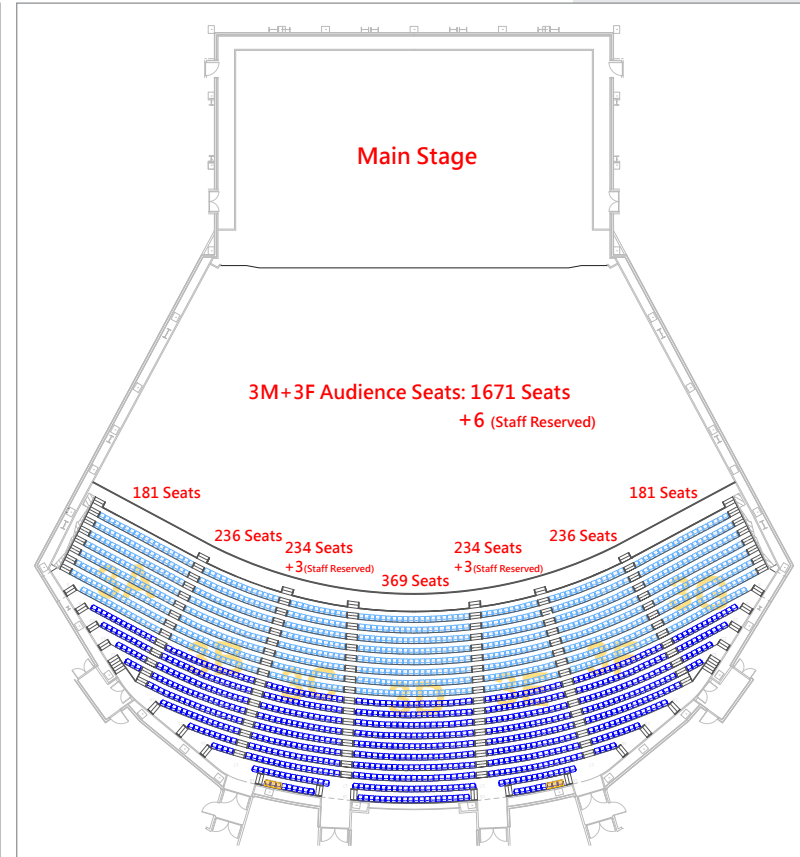

STAGE



Main Stage

- Main stage dimension: 35m wide, 20.37m deep, 20m high (from bottom of mother truss to stage), and with an area of about 700m².
- Proscenium dimension: 24.66m wide and 17.5m high
- The stage can be divided as two sections (front and back): the elevator platform can be adjusted in advance. Elevator platform can be planned according to production requirements. Application form is required to adjust the height of the elevator platform. Can only be operated by the technicians of the venue.

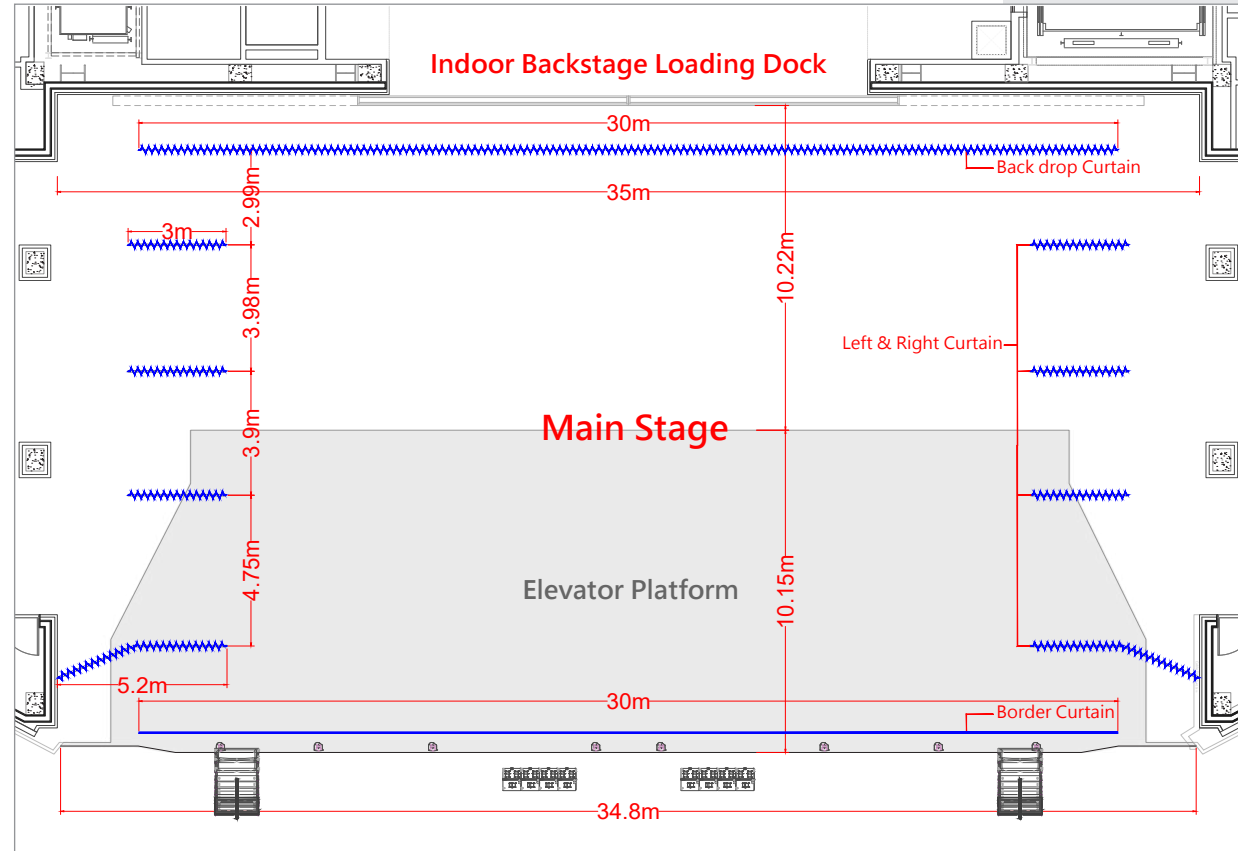

▲ Top view of main stage and curtains

Stage Curtains

Left and Right Curtain

There are 8 in total, 4 on each side. Stage left and right drapes are sound insulation curtains.

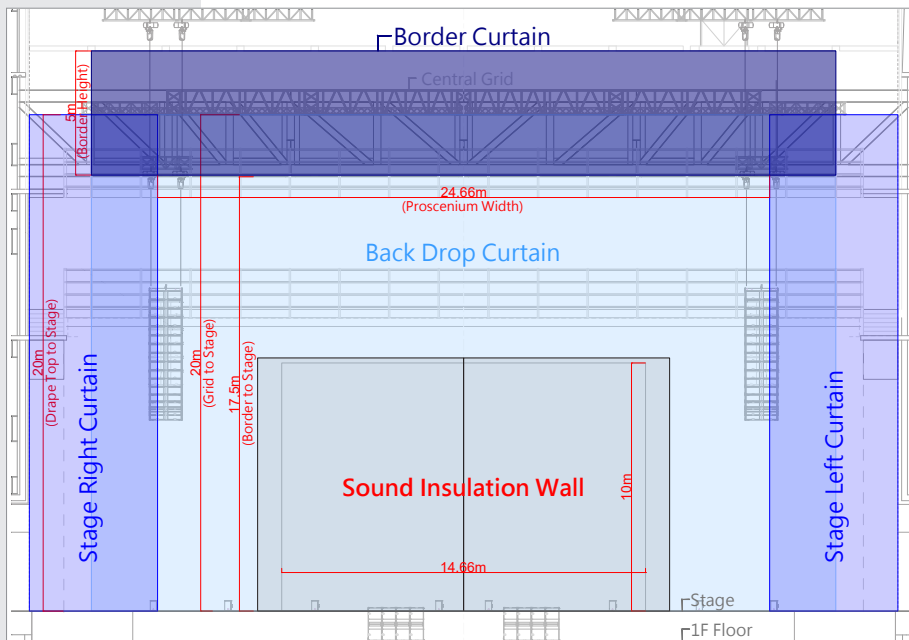

▲ Front view of main stage, curtains, and the sound insulation wall

Please refer to Appendices I – IV of the Stage Plan on pg. 58-61 for more details.

- First curtain is 5.2m wide and 20m high (from bottom edge of the stage left and right truss to stage).
- Second to fourth curtains are 3m wide and 20m high (from bottom edge of the stage left and right truss to stage).

Curtains are fixed on the stage left and right trusses.

Can remain or remove depending on production requirements. Application forms should submit in advance, and all items must be restored after the event.

Back Drop Curtain

There is a motor-operated back drop curtain at up stage.

- Back drop curtain dimension: 30m wide and 20m high

Fixed Border Curtain

There is a fixed border curtain above downstage.

- Fixed border curtain dimension: 30m wide and 5m high

Sound Insulation Wall

Sound insulation wall is set at the back of main stage. The wall should open during load-in and load-out, but closed during rehearsals and performances to avoid noise disturbances. The sound insulation wall should operate by the venue technicians only.



Elevator Platform

14 separate elevator platforms are on the main stage. Organizers can amend the height according to production requirements. Can only be operated by the technicians of the venue.

► Top view of the elevator platform

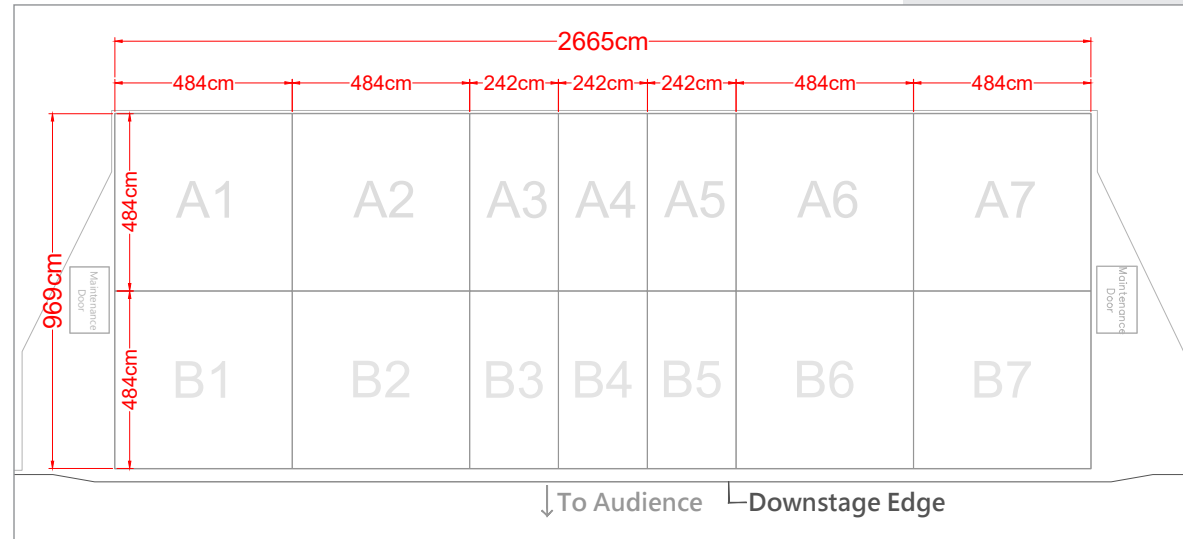

Elevator platform specifications are as follows:

- 14 separated platforms are divided as Row A and Row B.
Consist of two different platform dimensions: 484cm wide x 484cm deep, and 242cm wide x 484cm deep.
- The height of the base is relevant to the backstage loading area.
- Stage height is 120cm.
- The platform can elevate above stage at maximum height of 100cm.
- The platform can descend below stage level down to -380cm.
- The elevation can range from (+100 to -380) total of 480cm.
- Loading capacity: the static load weight capacity is 750kg/m², and the dynamic load weight capacity is 450kg/m².

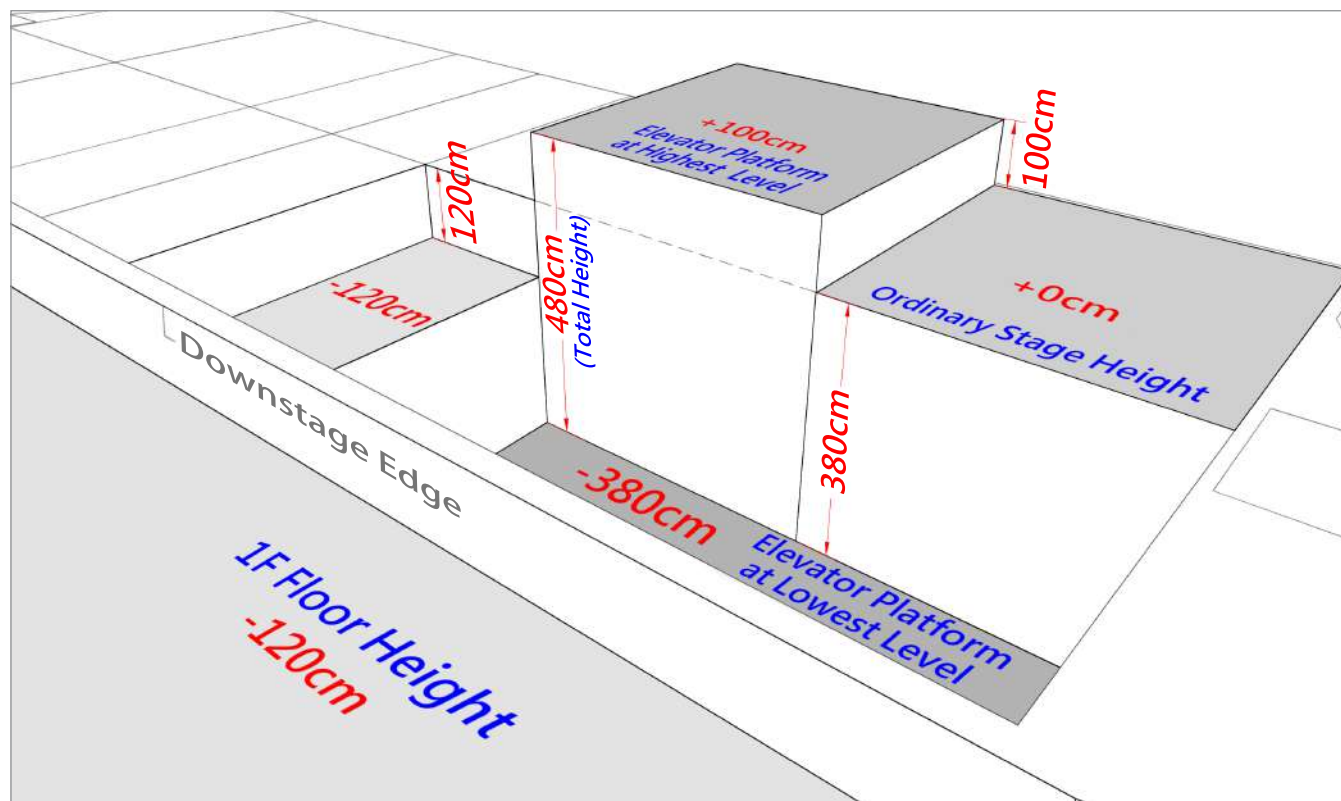

▲ Elevator platform in various heights

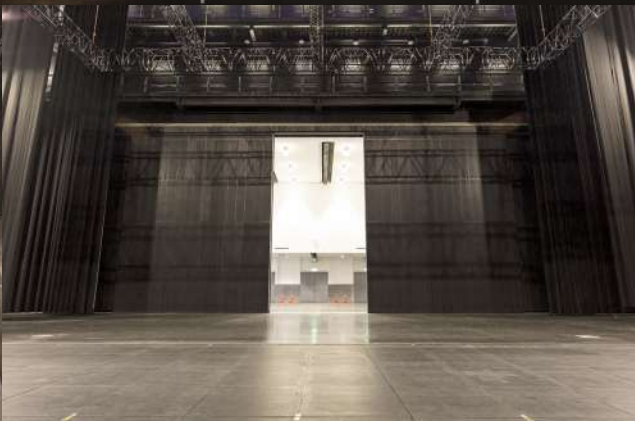

RIGGING



Main Stage – Mother Truss Grids

Main stage rigging system consists of three truss grids. The central grid and stage left and right grids can be adjusted by the venue technicians.

Specifications of the mother truss grids are as follows:

- The system includes: central grid, stage left and right grids
- Central grid dimension: 23.94m wide and 15.6m deep
Truss model & dimension: Global Truss U950 (W58cm x H101cm)
- Stage left and right grids dimension: 3.04m wide and 14.58m deep
Truss model & dimension: Global Truss U520 (W52cm x H52cm)
- The average loading capacity of the center grid: 30 metric tons , 2tons/point
- The average loading capacity of the stage left and right grids: 5.6 metric tons , 700kg/point

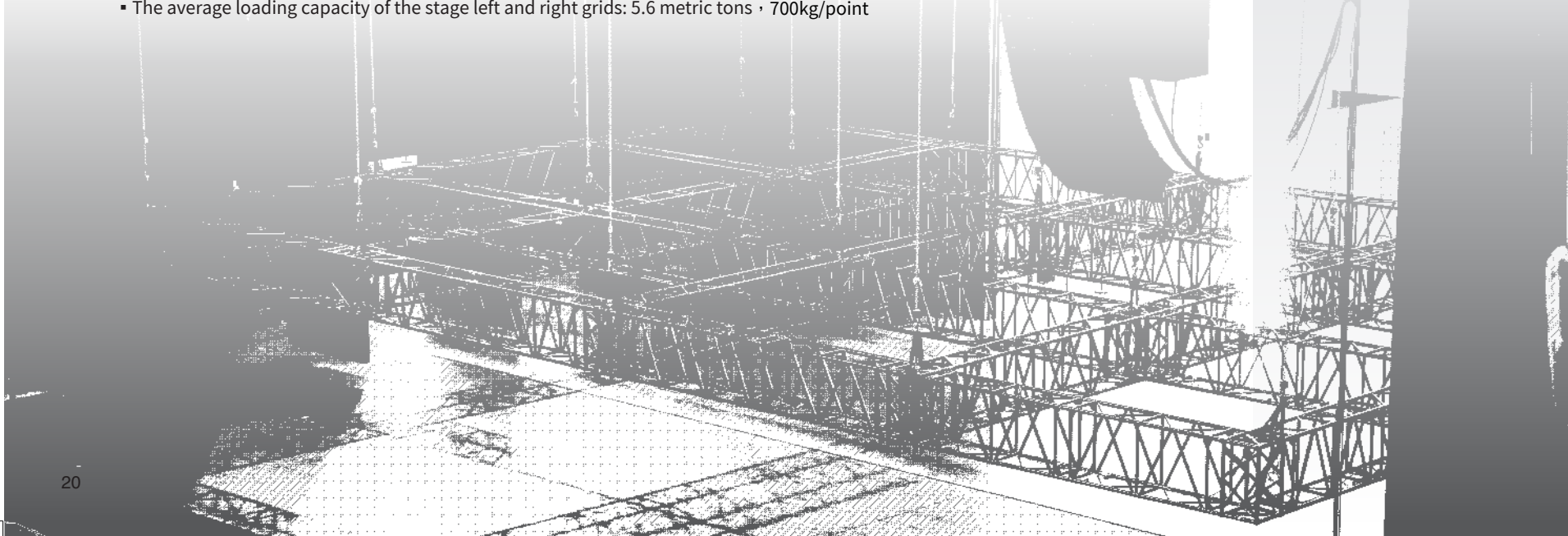

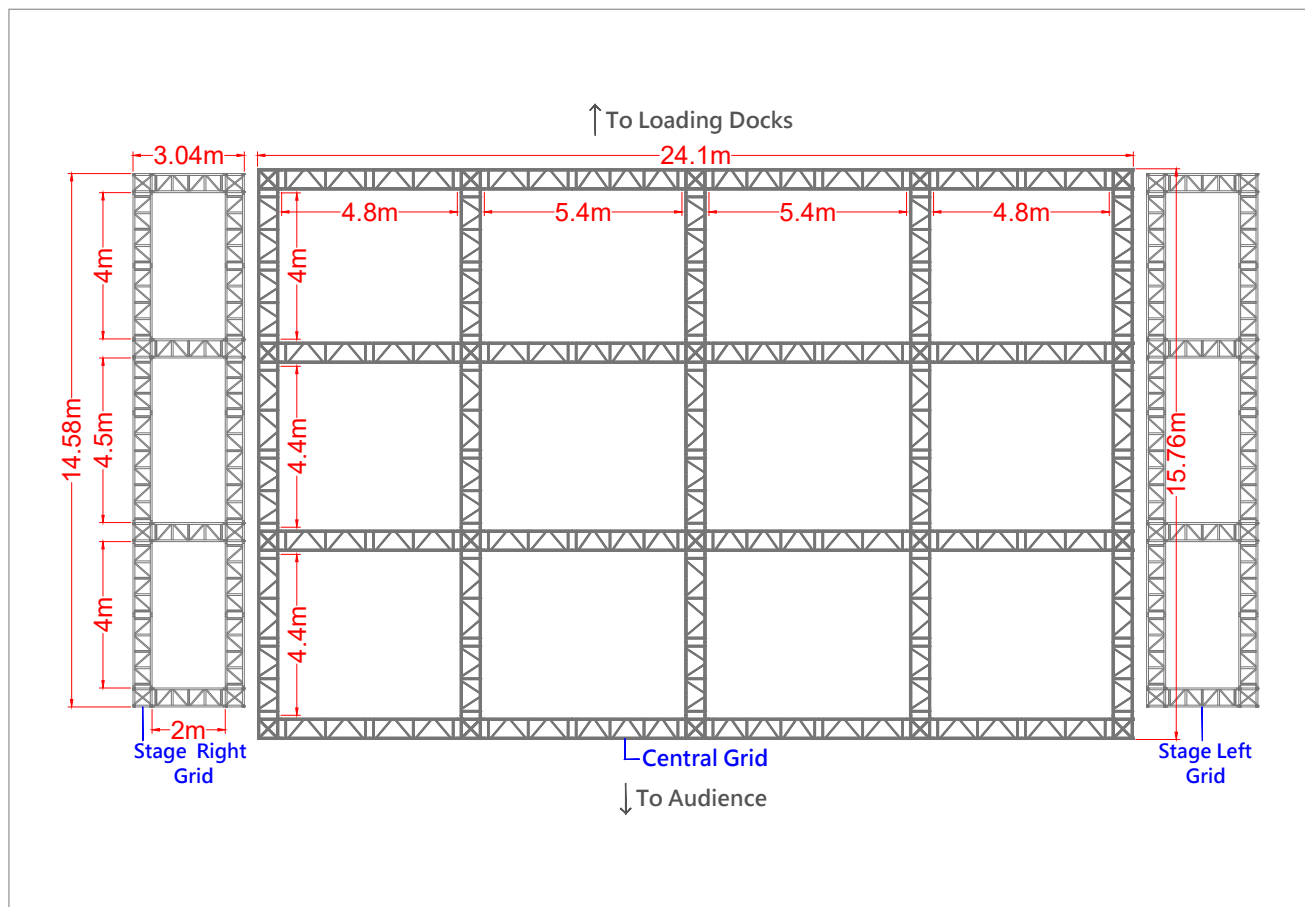

▲ Mother truss grids of main stage



Ground Floor – Existing and Additional Rigging Points

There are 15 rigging points and hoists available above the audience ground floor. Additional rigging points can be added upon request.

Existing Rigging Points

- A total of 15 rigging points separated on 3 rigging trusses.
- Maximum loading for each rigging point: 800kg/point
- When the rigging point is used on the ground floor, the chains should not have direct friction with the catwalk structure. Protections and safety measures should be considered.

Additional Rigging Points

- If additional rigging is required, rigging points can be added on the beams above the audience ground floor only.
- Maximum loading for each rigging point is 2 metric tons, and the minimum distance required between each rigging point should be 3m.

Please refer to Appendix V of the Rigging Plan on pg. 62 for more details.

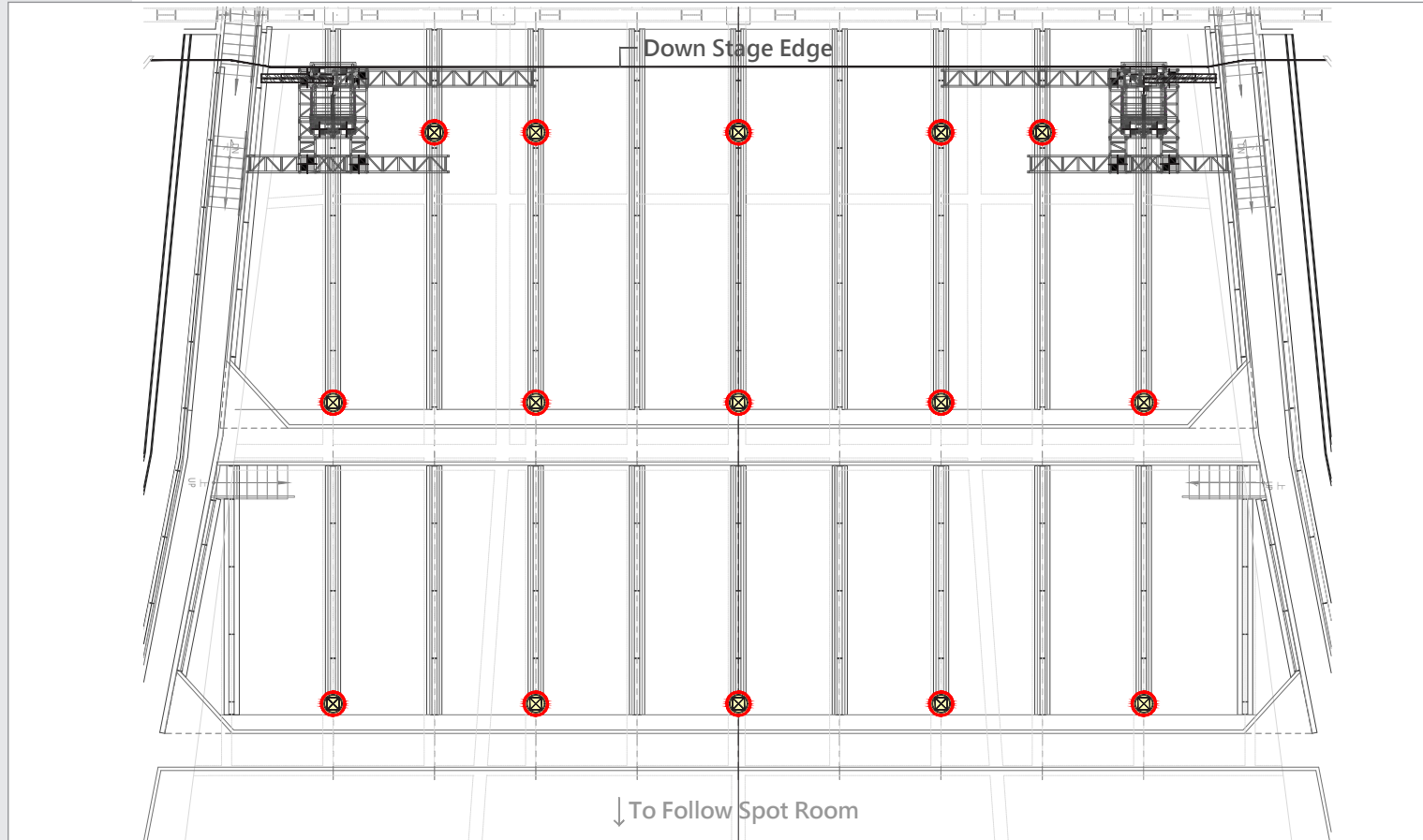

▲ Existing rigging points above ground floor

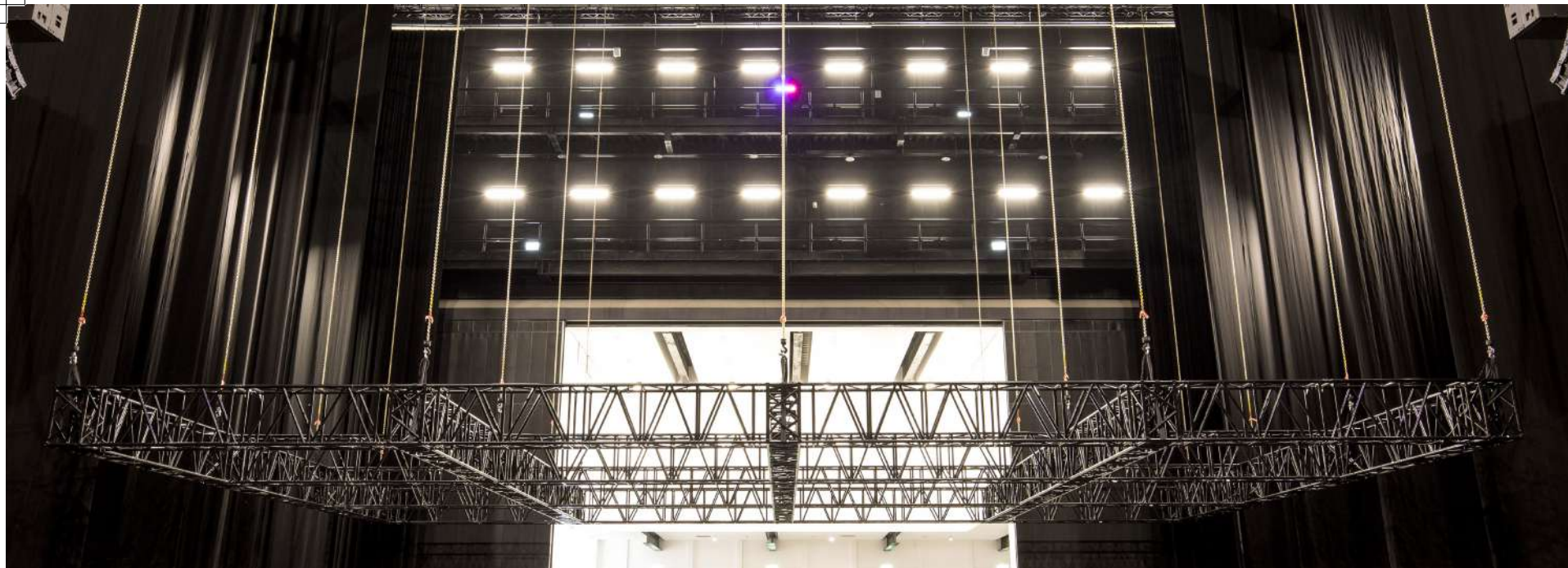



AUDIO



Audio Equipment List

The Concert Hall is equipped with a L-Acoustics audio system with the following specifications:

Item	Brand and Model	Qty	Unit
Audio console	Avid Venue S6L 24C+E6L-144	1	Set
Stage rack	Avid Venue Stage64	1	Set
Main linear-array speaker	L-Acoustics K2	32	Piece
Front fill at down stage edge	L-Acoustics X8	8	Piece
Linear-array subwoofer (flown)	L-Acoustics KS28	12	Piece
Linear-array subwoofer (ground)	L-Acoustics KS28	8	Piece
Stage monitoring wedges	L-Acoustics X15 HiQ	8	Piece
Balcony fill at 2F balcony	L-Acoustics X8	12	Piece
Delayed linear-array speakers at 3F balcony	L-Acoustics KARA	8	Piece
4-loop 1400W amplifier	L-Acoustics LA12X	18	Set
4-loop 1400W amplifier	L-Acoustics LA4X	8	Set
Multi-functional signal processor	L-Acoustics LA-P1	1	Set

Sound Pressure Data

SPEAKER OVERVIEW

- (A) Main Speaker: L-Acoustics K2 x 16 per-side
- (B) Flown Sub: L-Acoustics KS28 x 6 per-side
- (C) Ground Sub: L-Acoustics KS28 x 8 total
- (D) Front Fills: L-Acoustics X8 x 8 total
- (E) Balcony Fills: L-Acoustics X8 x 12 total
- (F) Delay: L-Acoustics KARA x 4 per-side

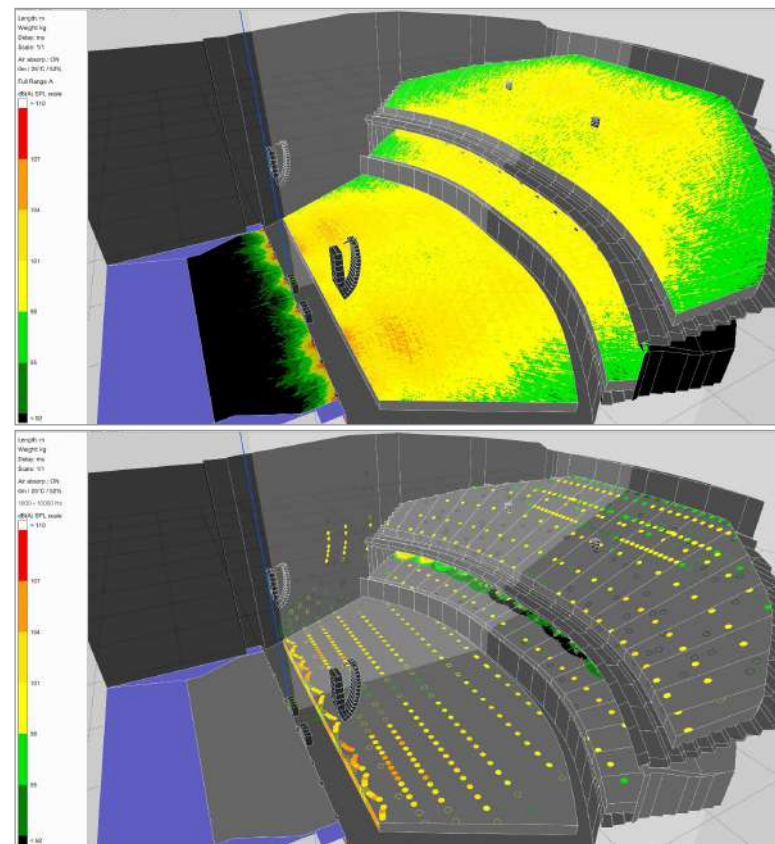



MAIN SPEAKER

L-Acoustics K2 x 16 per-side

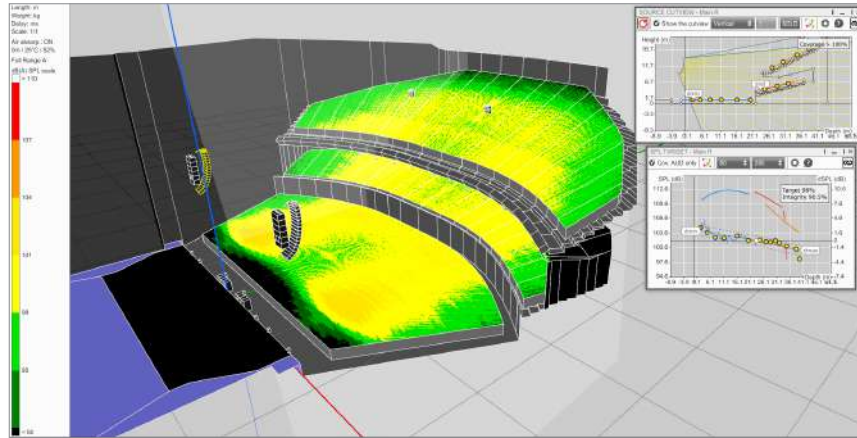

FRONT FILLS

L-Acoustics X8 x 8 total

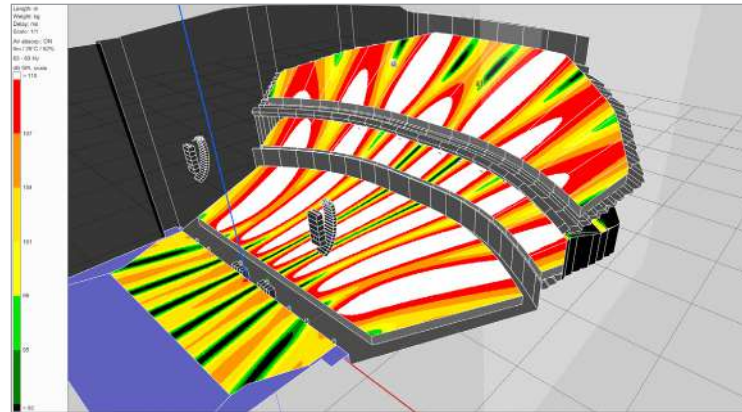
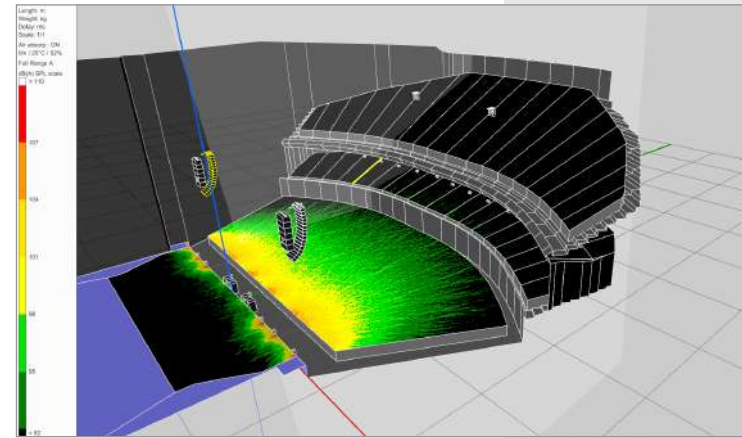

FLOWN SUB

L-Acoustics KS28 x 6 per-side

GROUND SUB

L-Acoustics KS28 x 8 total

BALCONY FILLS

L-Acoustics X8 x 12 total

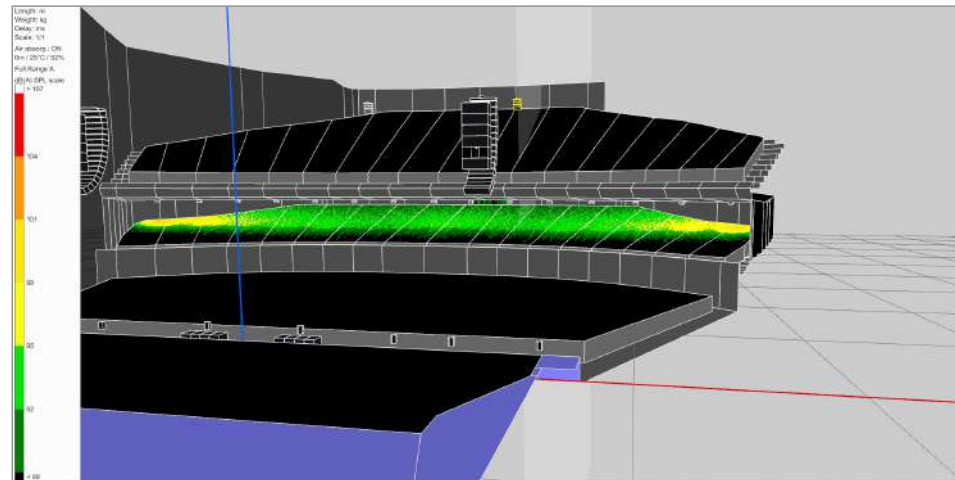

DELAY

L-Acoustics KARA x 4 per-side

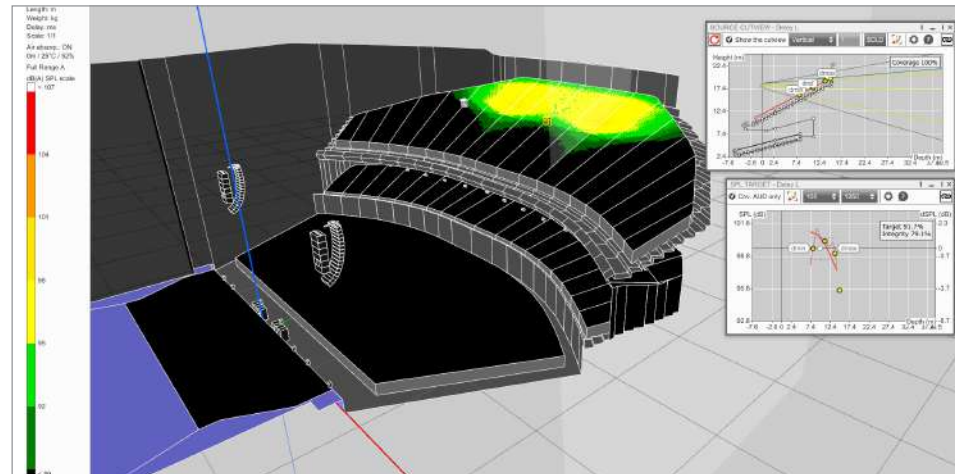



Sound System Floorplan

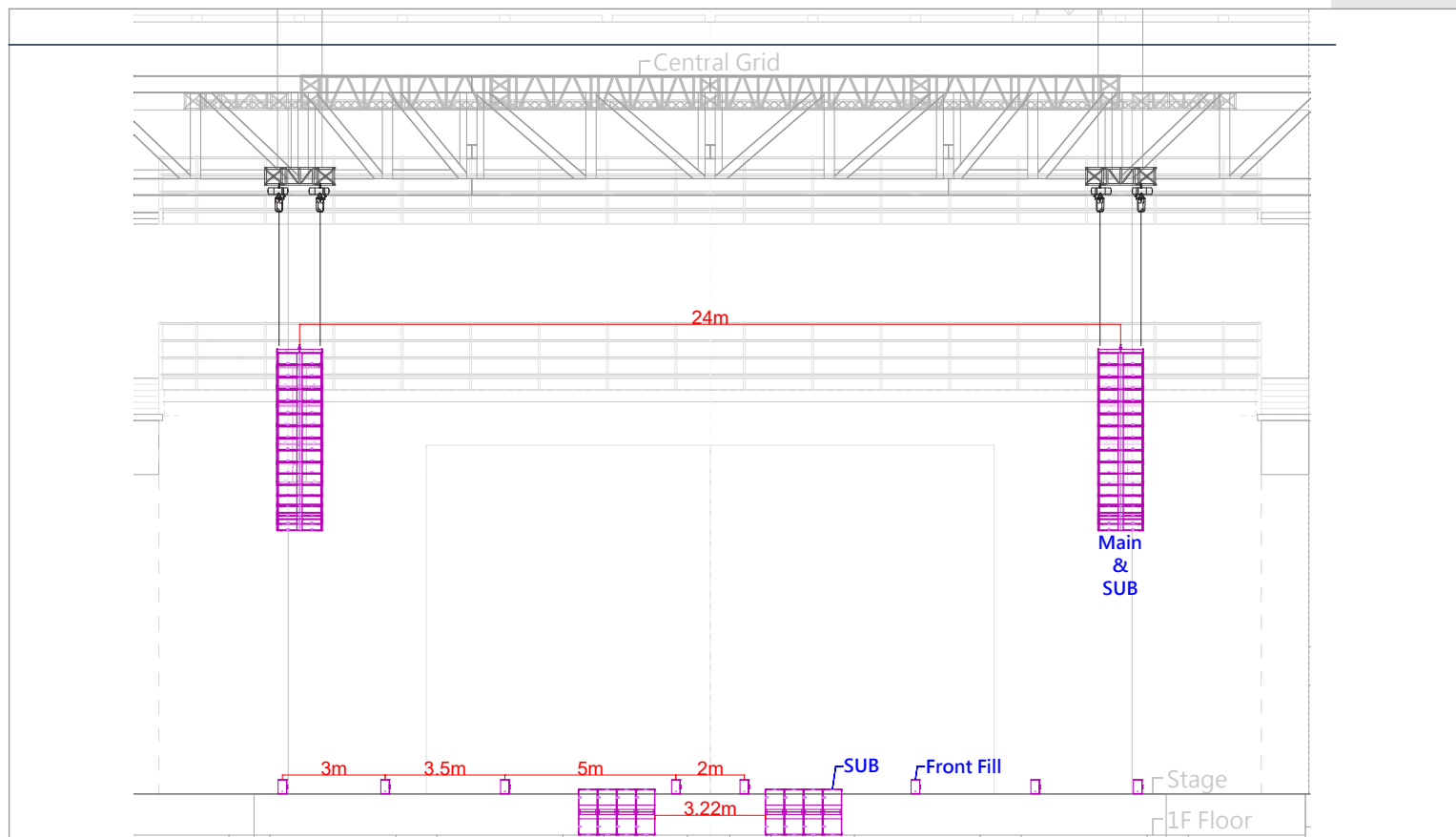

▲ Front view of audio set up

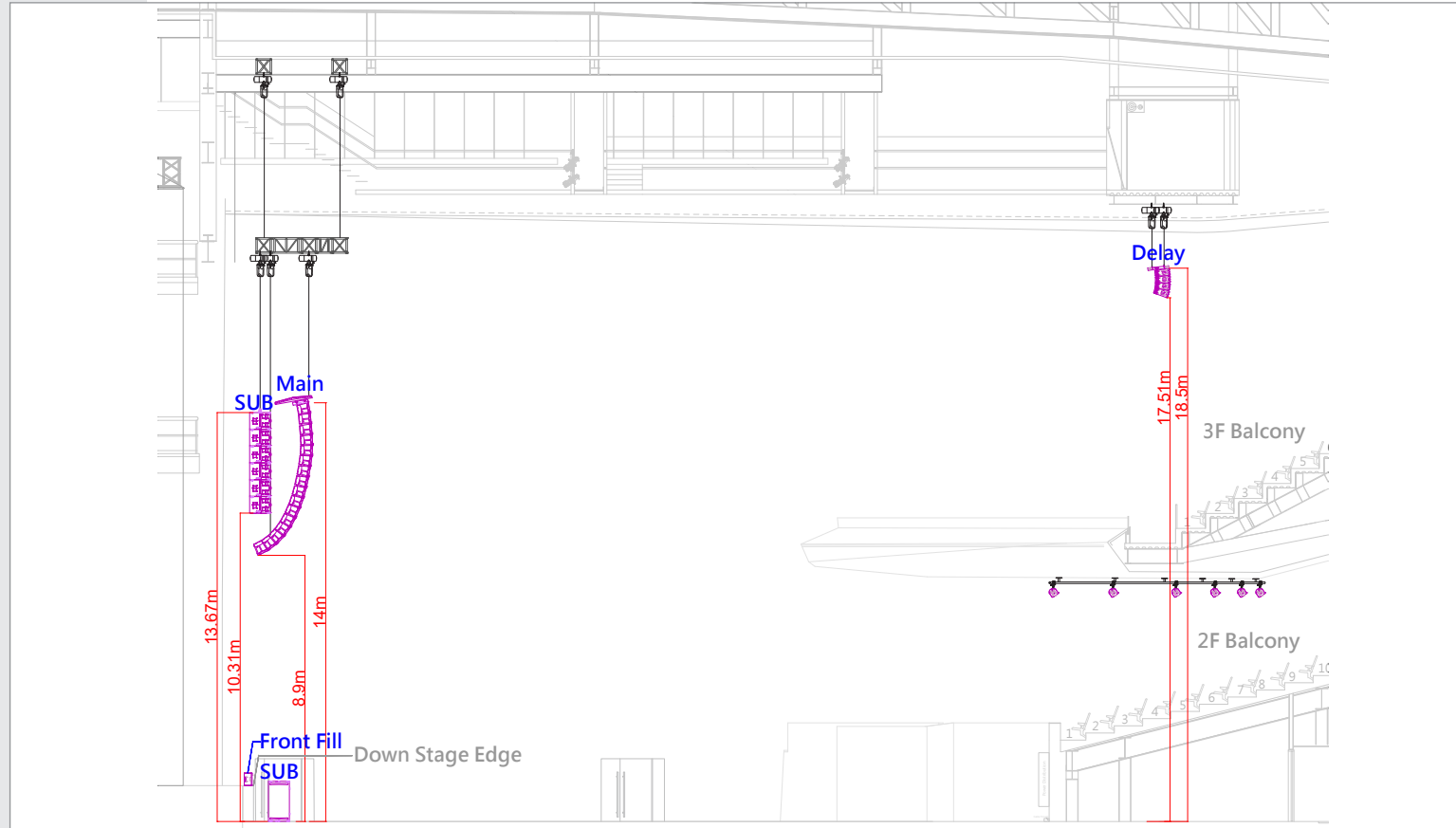

▲ Side view of audio set up



LIGHTING



Lighting Equipment List

There are 16 LED Fresnel align above stage left and right, and 80 LED Leko above audience ground floor. Furthermore, there are 4 4KW follow spots in the follow spot room.

Item	Brand and Model	Specification	Qty	Unit
Lighting console	ETC Element 2	1024 output	1	Set
LED Leko	URANUS LES-300A 10°	300W	80	Piece
DMX Signal distributor	ACME CA-DS18	1 IN/8 OUT	6	Set
Follow spot	ROBERT JULIAT LANCELOT 4000W HTI	4000W	4	Piece

Please refer to Appendix VI of light plan on pg. 63 for more details.

Lighting System Floorplan

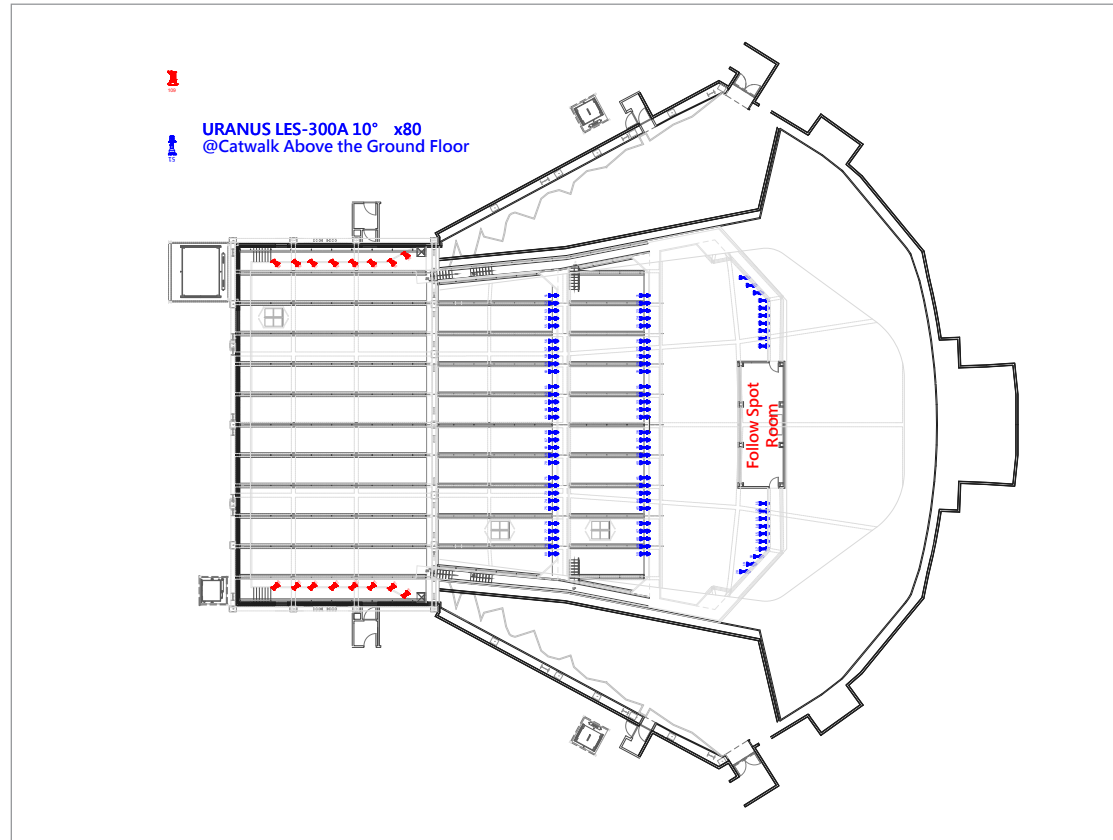

▲ Lighting plan and the follow spot room



Follow Spot Floorplan

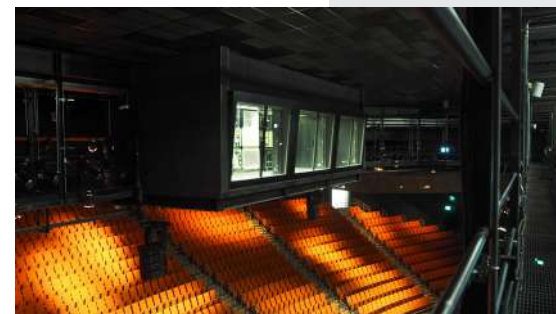
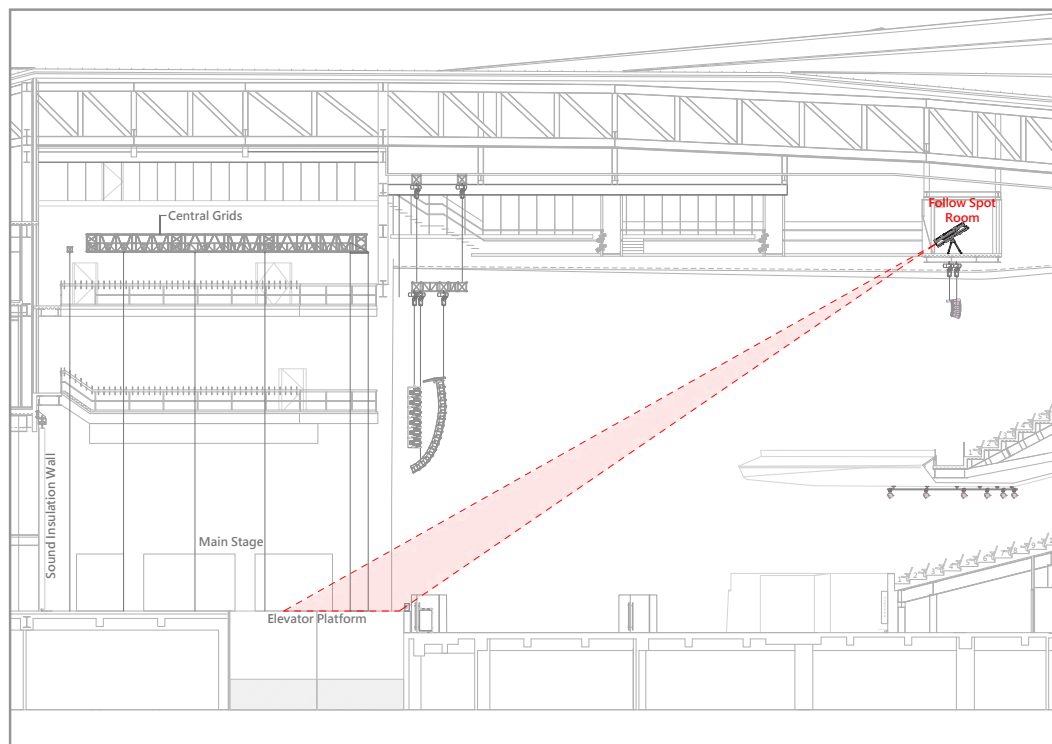

- ▲ Follow spot room
- ◀ Follow spot lighting illustration

BROADCASTING HUB NETWORK



LEMO Video Monitoring Broadcasting System

LEMO signal panels are set in different areas of the venue; organizers can transmit camera signals to the cable room via LEMO connectors and connect signals with OB vans via the connection panel in the signal cable room.

LEMO connector specifications: Hybrid Fiber-optic (HFO) Camera Connector

LEMO Panel Number and Location

No. Location Floor	Photography LEMO Panel			
	Panel No.	Channel Qty	Interface No.	Floor Location
1F	LEMO 100 (LEMO connection panel to the outside OB van)	26CH	No.1 ~ No.26	Signal cable room
	LEMO 101	2CH	No.1 ~ No.2	Downstage left
	LEMO 102	2CH	No.3 ~ No.4	Downstage right
	LEMO 103	2CH	No.5 ~ No.6	1F back of house, right
	LEMO 104	2CH	No.7 ~ No.8	1F back of house
	LEMO 105	2CH	No.9 ~ No.10	
	LEMO 106	2CH	No.11 ~ No.12	1F back of house, left
2F	LEMO 201	8CH	No.13 ~ No.20	2F Zone E
3F	LEMO 401	4CH	No.21 ~ No.24	3F back of house
RF	LEMO 501	2CH	No.25 ~ No.26	On catwalk above main stage

LEMO Panel Configuration

▼ 1F LEMO panels

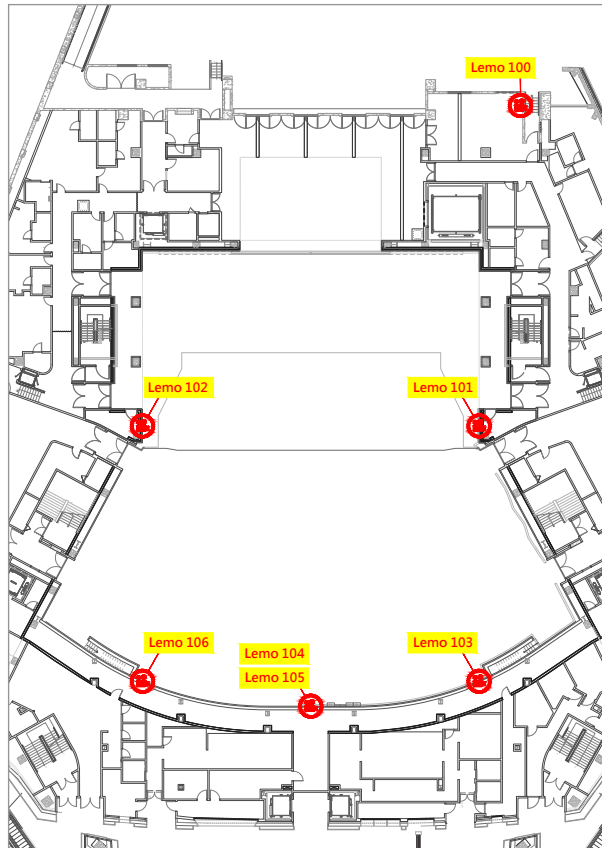

▼ 2F LEMO panels

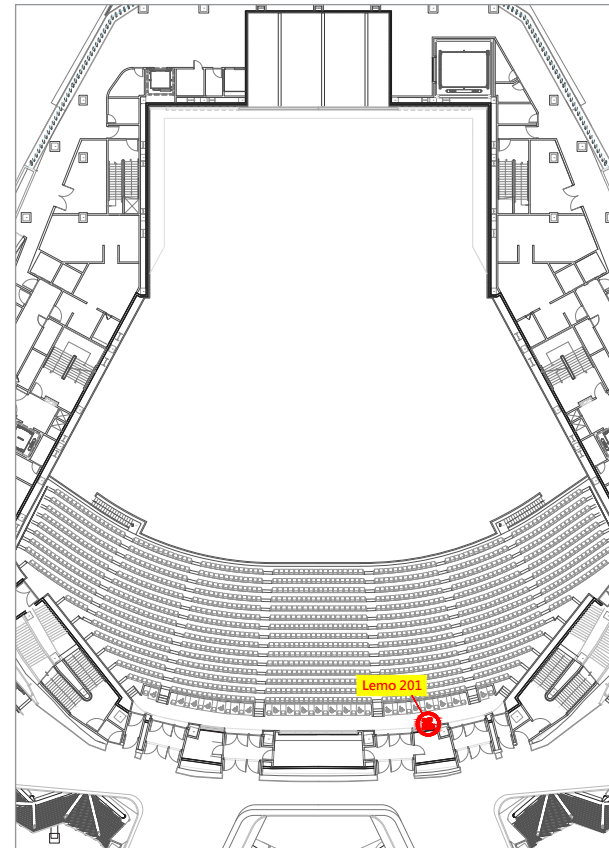



▼ 3F LEMO panels

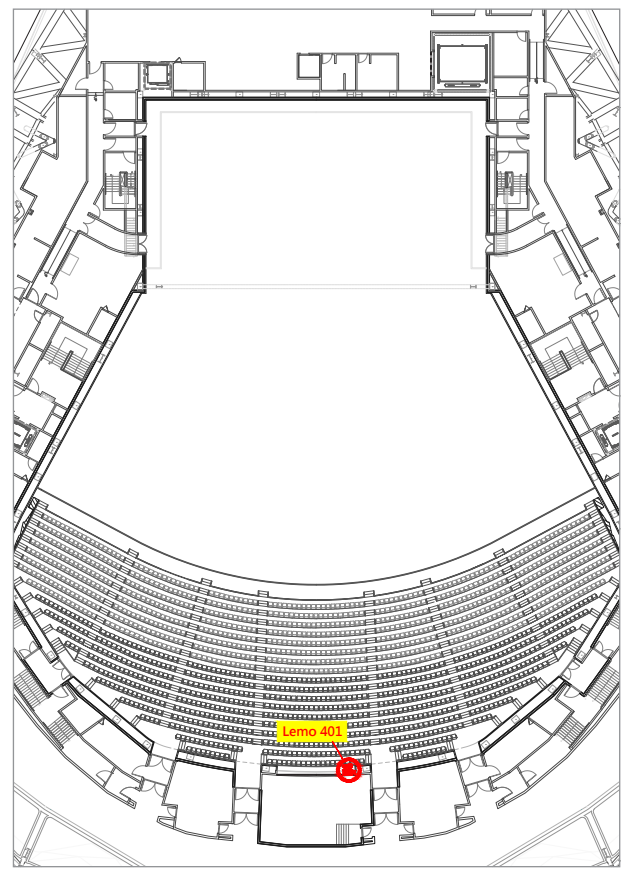

▼ RF LEMO panels

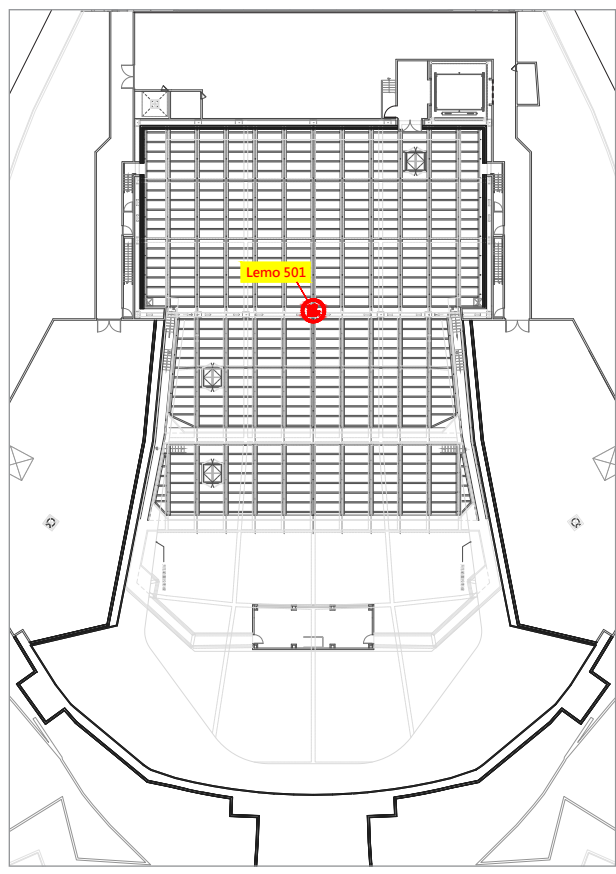

Other Hub Network Systems

Hub signal panels are available throughout different areas of the venue, including an optical fiber network, internet network, Intercom and camera signal panels. Organizers can utilize the signal system according to their needs.

Optical fiber connector specifications: optical con or Lucent Connector
Camera BNC connector specifications: 75ΩBNC

Optical Fiber and Camera BNC Panel Number and Location

No. Location Floor	Optical Fiber and Camera BNC Panel				
	Panel No.	Optical Fiber Interface		Camera BNC Interface	Floor Location
		Single-Mode (SM)	Multi-Mode (MM)		
1F	AV110	1, 2	1, 2	1, 2	Downstage right
	AV111	1, 2	1, 2	-	Stage right quick change room
	AV112	1, 2	1, 2	-	Upstage right
	AV113	1, 2	1, 2	-	Upstage left
	AV114	1, 2	1, 2	-	Stage left quick change room
	AV115	1, 2	1, 2	1, 2	Downstage left
	AV116	1, 2	1, 2	-	1F back of house
	AV213	1, 2	1, 2	1, 2	



No. Location Floor	Optical Fiber and Camera BNC Panel				
	Panel No.	Optical Fiber Interface		Camera BNC Interface	Floor Location
		Single-Mode (SM)	Multi-Mode (MM)		
1F	AV216	1, 2	1, 2	1, 2	1F back of house
	AV117	1, 2	1, 2	1, 2	1F back of house, right
	AV118	1, 2	1, 2	1, 2	1F back of house, left
	AV119	1 - 8	1 - 8	-	Signal cable room
	AV123	-	-	1 - 21	
2F	AV234	1 - 4	1 - 4	1, 2	2F Zone E
3F	AV301	1	1	-	3F front of house
	AV302	1	1	-	
	AV303	1	1	-	
	AV405	1, 2	1, 2	-	3F back of house
RF	AV501	1, 2	1, 2	-	On catwalk above main stage
	AV502	1, 2	1, 2	-	
	AV503	1, 2	1, 2	-	
	AV504	1, 2	1, 2	1, 2	
	AV505	1, 2	1, 2	-	

Optical Fiber and Camera BNC Panel Configuration

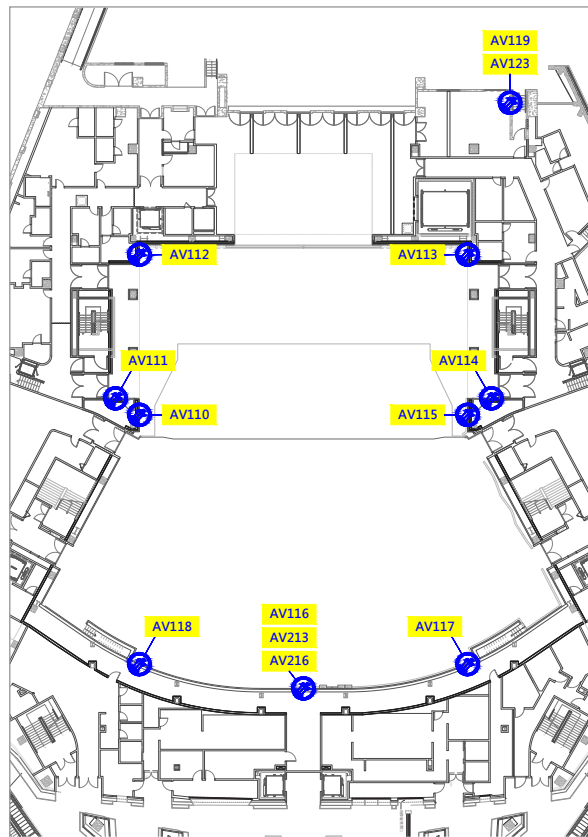

▲ 1F optical fiber and camera BNC panels

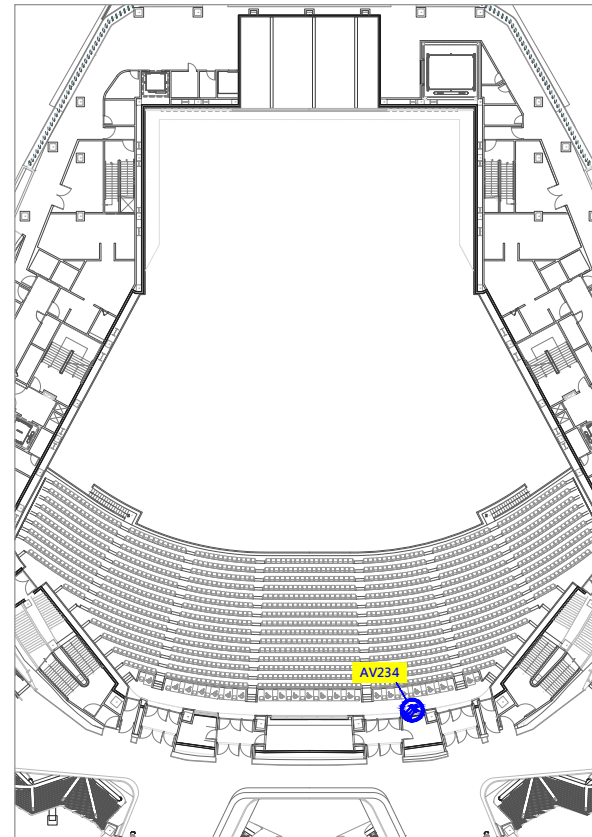

▲ 2F optical fiber and camera BNC panels

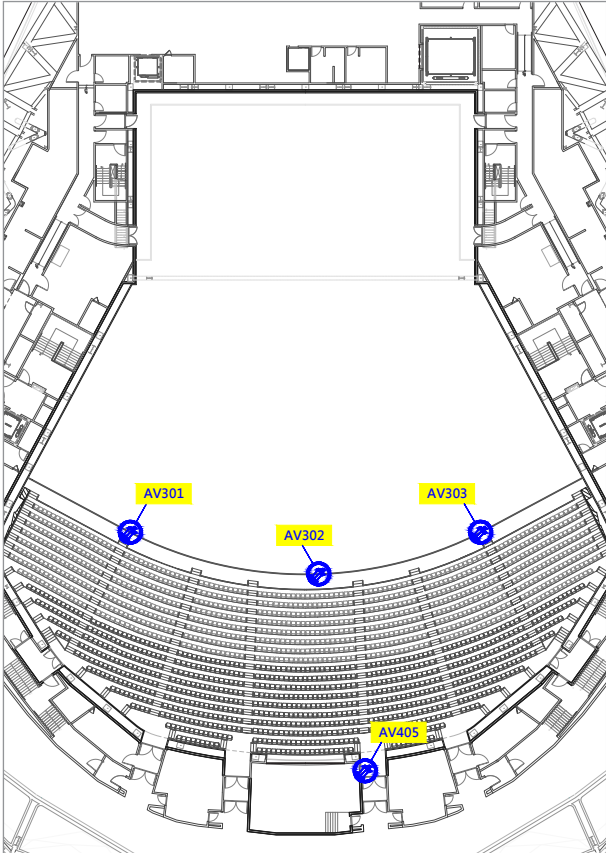

▲ 3F optical fiber and camera BNC panels

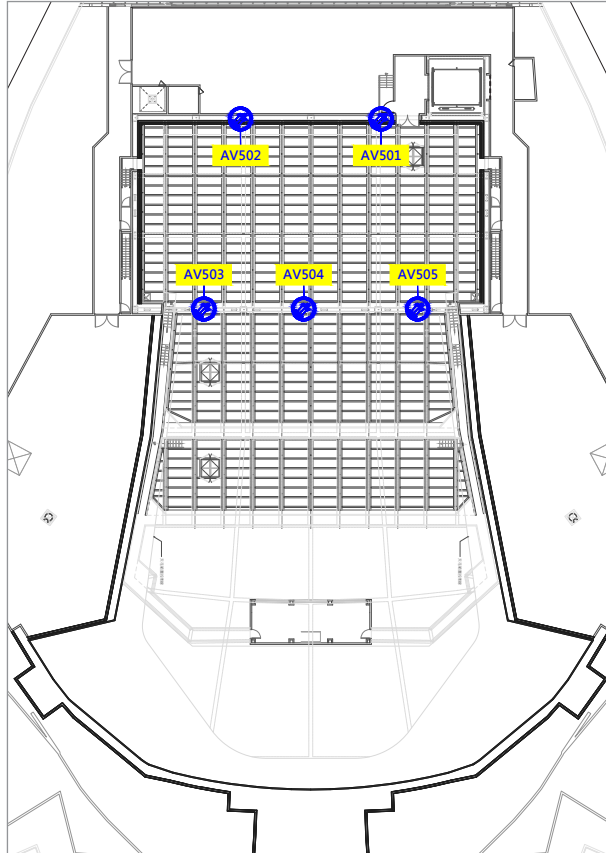

▲ RF optical fiber and camera BNC panels

POWER



Switchboard Number and Location

The venue equips with the following power system, including power switchboards that are located on both sides of the stage for organizers to utilize.

No. Location Floor	Switchboard				
	Switchboard No.	Power Specification	Protection Switch Capacity	Maximum Available Power	Floor Location
1F	1F-CS-A	3Φ4W 220/380V	125A	100A	Signal cable room
	1F-CS-H	3Φ4W 120/208V	200A	160A	
	1F-CS-B	3Φ4W 220/380V	125A	100A	
	1F-CS-G	3Φ4W 120/208V	200A	160A	
	1F-CS-D Lighting	3Φ4W 220/380V	400A	320A	Stage left
	1F-CS-D1(J)	3Φ4W 120/208V	400A	320A	
	3F-CS-B Stage Mechanics	3Φ4W 220/380V	400A	320A	
	3F-CS-E	3Φ4W 120/208V	400A	320A	
	3F-CS-F	3Φ4W 120/208V	400A	320A	
	1F-CS-E Audio	3Φ4W 220/380V	200A	160A	
	1F-CS-L	3Φ4W 120/208V	200A	160A	
	1F-CS-I	3Φ4W 120/208V	100A	80A	
	1F-CS-O	3Φ4W 120/208V	100A	80A	
	1F-CS-R	3Φ4W 120/208V	100A	80A	
	Mobilized Audio Power Cabinet	3Φ4W 220/380V	100A	80A	
	1F-CS-R	3Φ4W 120/208V	100A	80A	
	4F-CS-D Video	3Φ4W 220/380V	400A	320A	Stage right
	4F-CS-E Lighting	3Φ4W 220/380V	400A	320A	
	4F-CS-J	3Φ4W 120/208V	400A	320A	
	4F-CS-K	3Φ4W 120/208V	400A	320A	
	3F-CS-C Stage Mechanics	3Φ4W 220/380V	400A	320A	
	1F-CS-F Audio	3Φ4W 220/380V	200A	160A	

No. Location Floor	Switchboard				
	Switchboard No.	Power Specification	Protection Switch Capacity	Maximum Available Power	Floor Location
1F	1F-CS-K	3Φ4W 120/208V	200A	160A	Stage right
	1F-CS-C	3Φ4W 220/380V	125A	100A	
	Mobilized Audio Power Cabinet	3Φ4W 220/380V	100A	80A	
	1F-CS-P	3Φ4W 220/380V	100A	80A	1F back of house
	2F-CS-C	3Φ4W 120/208V	100A	80A	
	2F-CS-B	3Φ3W 220V	100A	80A	
	4F-CS-H Lighting Console FOH	3Φ4W 120/208V	200A	160A	
RF	5F-CS-C Lighting	3Φ4W 220/380V	200A	160A	On catwalk above main stage
	5F-CS-D Chain Hoists	3Φ4W 220/380V	400A	320A	
	5F-CS-I	3Φ4W 120/208V	400A	320A	
	5F-CS-E Audio	3Φ4W 220/380V	200A	160A	
	5F-CS-B Lighting	3Φ4W 220/380V	125A	100A	
	5F-CS-H	3Φ4W 120/208V	200A	160A	
	5F-CS-A Chain Hoists	3Φ4W 220/380V	400A	320A	
	5F-CS-G	3Φ4W 120/208V	400A	320A	
	5F-CS-K2	3Φ3W 200V	200A	160A	
	5F-CS-K1	3Φ3W 200V	200A	160A	
	5F-CS-K	3Φ3W 200V	200A	160A	
	5F-CS-F Chain Hoists and Lighting	3Φ4W 220/380V	400A	320A	On catwalk
	5F-CS-J	3Φ4W 120/208V	400A	320A	
	5F-CS-N	3Φ4W 120/208V	50A	40A	
	5F-CS-M	3Φ3W 200V	150A	120A	Follow spot room
	5F-CS-O	3Φ3W 200V	100A	80A	
Taipei Music Hall outdoor	1F-OB-A, 1F-OB-E and 1F-OB-G (the same loop)	3Φ4W 220/380V	400A	320A	North base
	1F-OB-B, 1F-OB-F and 1F-OB-H (the same loop)	3Φ4W 120/208V	400A	320A	
	1F-OB-C	3Φ4W 220/380V	125A	100A	
	1F-OB-D	3Φ4W 120/208V	200A	160A	



Switchboard Configuration

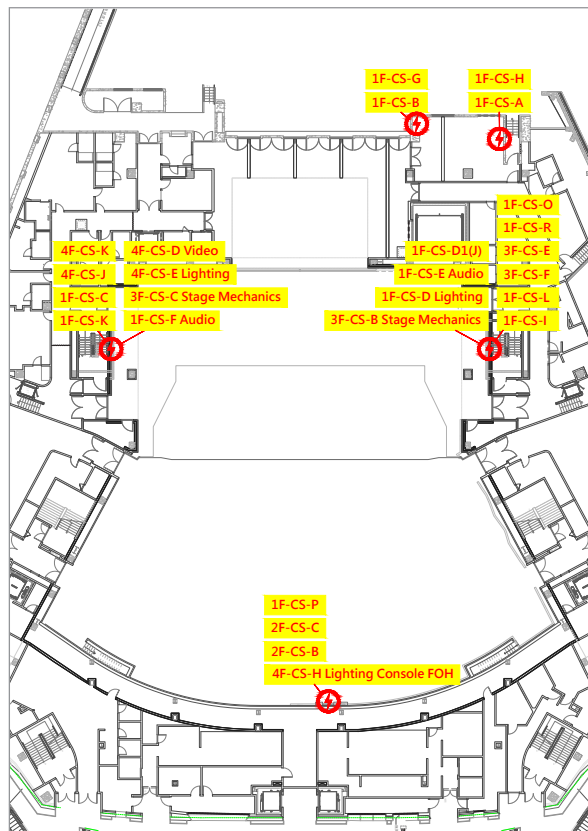

▲ 1F switchboards

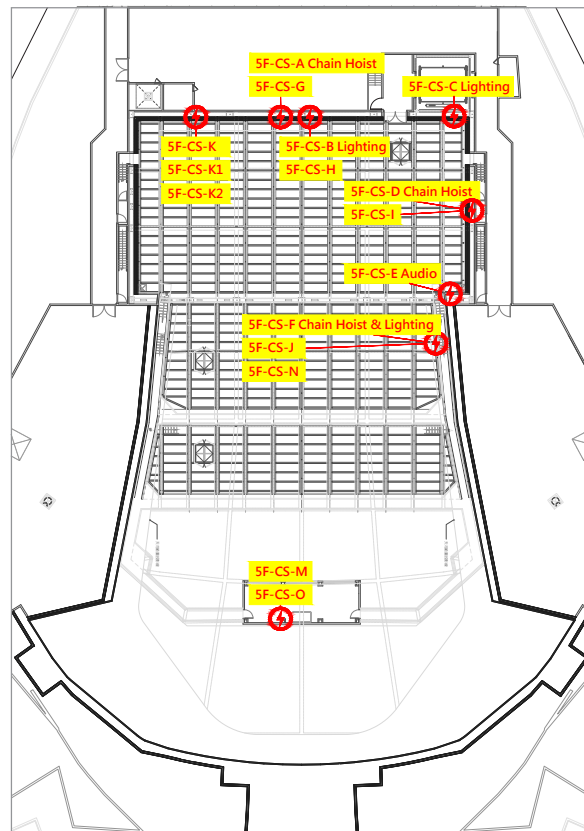

▲ RF switchboards

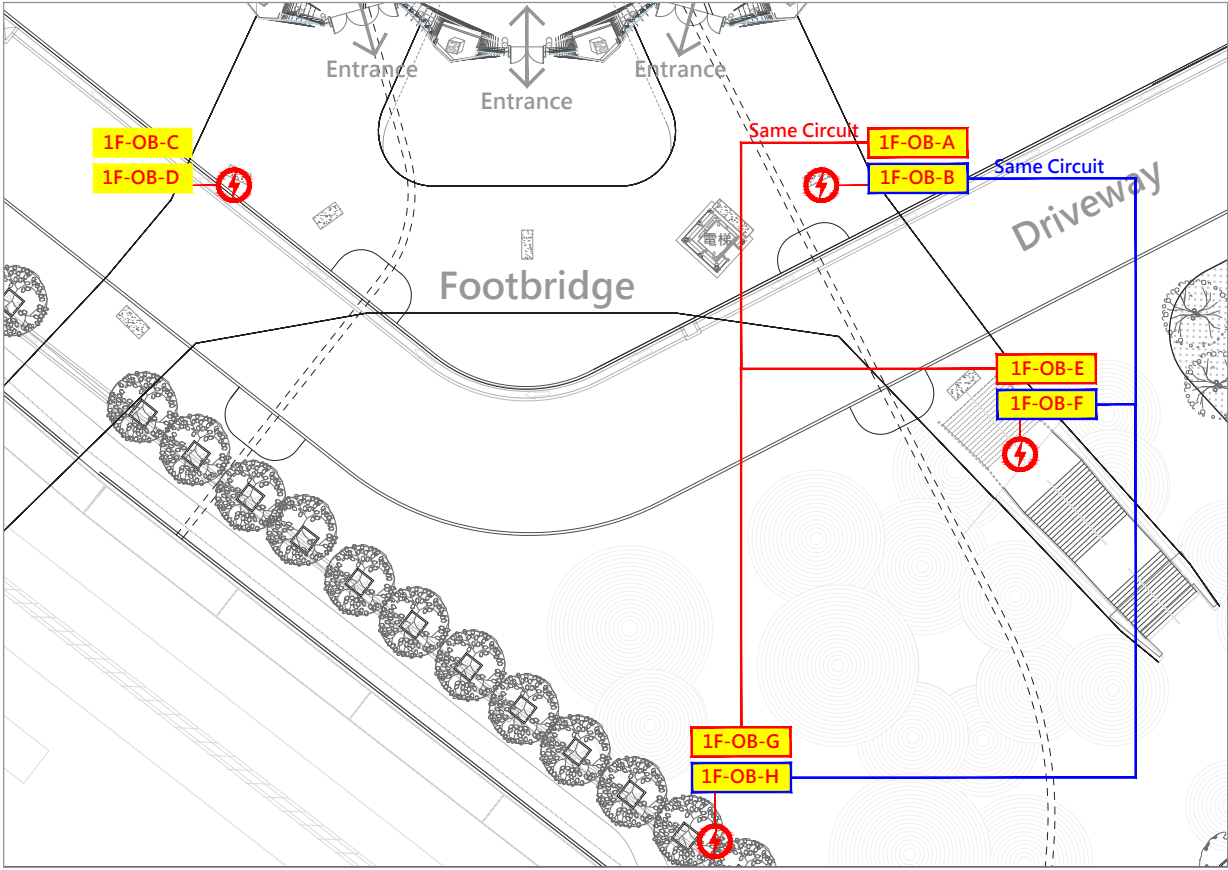

▲ Outdoor switchboards at Taipei Music Center North base

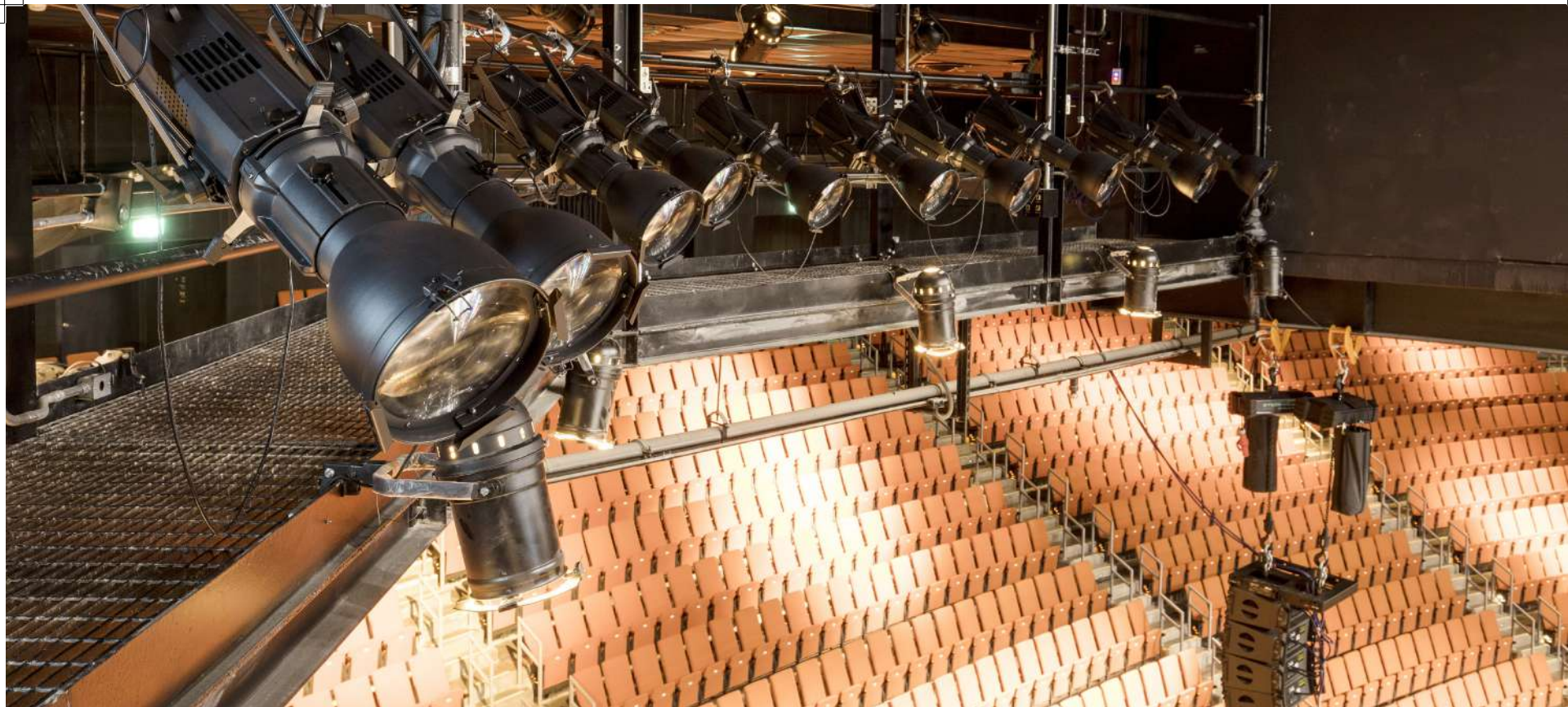



BACKSTAGE & DRESSING ROOM



Backstage and Dressing Rooms Facilities

Floor	Room No.	Space	Space Dimension (m ²)	Capacity	Restroom	Makeup Table	NBA Folding Chair	Portable Clothes Rack	Notes
1F	N1090	Dressing room (1)	11	2	1	2	-	-	2 barber chairs
	N1103	Dressing room (2)	24	5	2	3	5	1	
	N1098	Dressing room (3)	42	10	2	7	10	1	
	N1087	Dressing room (4)	16	3	1	3	2	1	2 barber chairs
	N1085	Dressing room (5)	18	5	1	-	-	-	
	N1080	VIP dressing room	63	10	1	2	-	1	2 barber chairs
	N1019	Quick-change room	11	2	-	-	-	-	
	N1074	Quick-change room	11	2	-	-	-	-	
	N1002	Signal cable room	71	25	-	-	24	-	8 folding tables
	N1005	Media center	24	4	-	-	-	-	
	N1006		161	30	-	-	-	-	
	-	FOH	-	-	-	-	20	-	6 folding tables

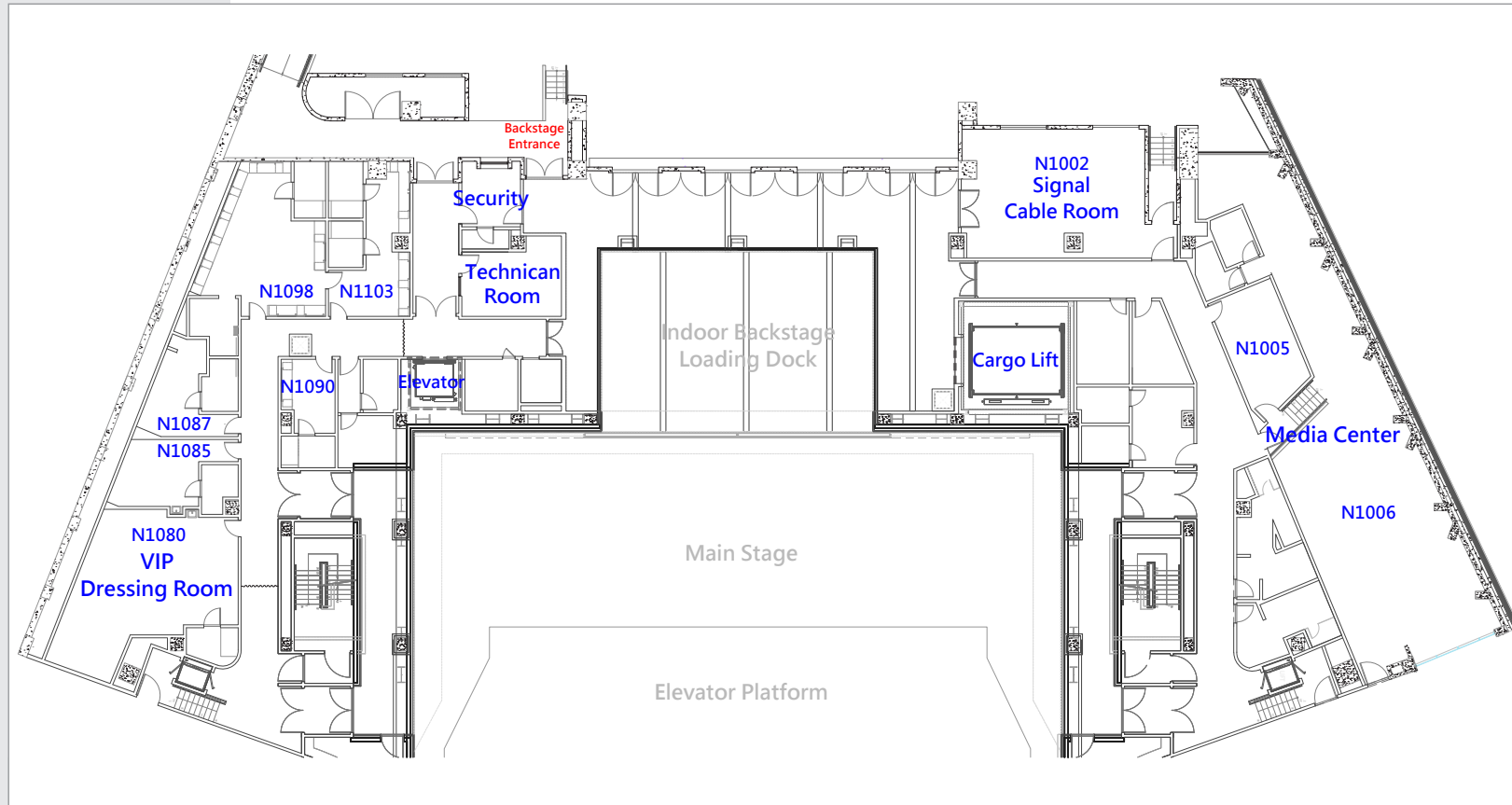

▲ 1F backstage and dressing rooms



Floor	Room No.	Space	Space Dimension (m ²)	Capacity	Restroom	Makeup Table	Folding Chair	Portable Clothes Rack
B1	NB1030	Dressing room	65	16	1	16	16	-
	NB1032		25	5	1	5	5	-
	NB1037		84	20	1	20	20	-
	NB1039		30	7	1	7	7	-

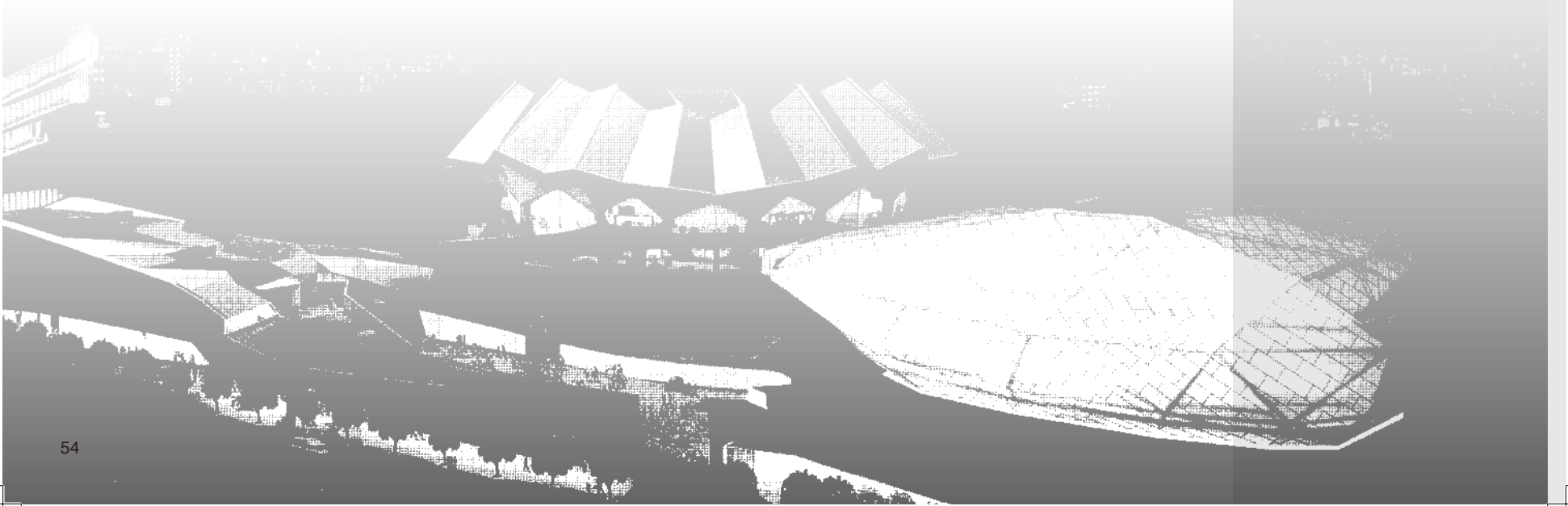

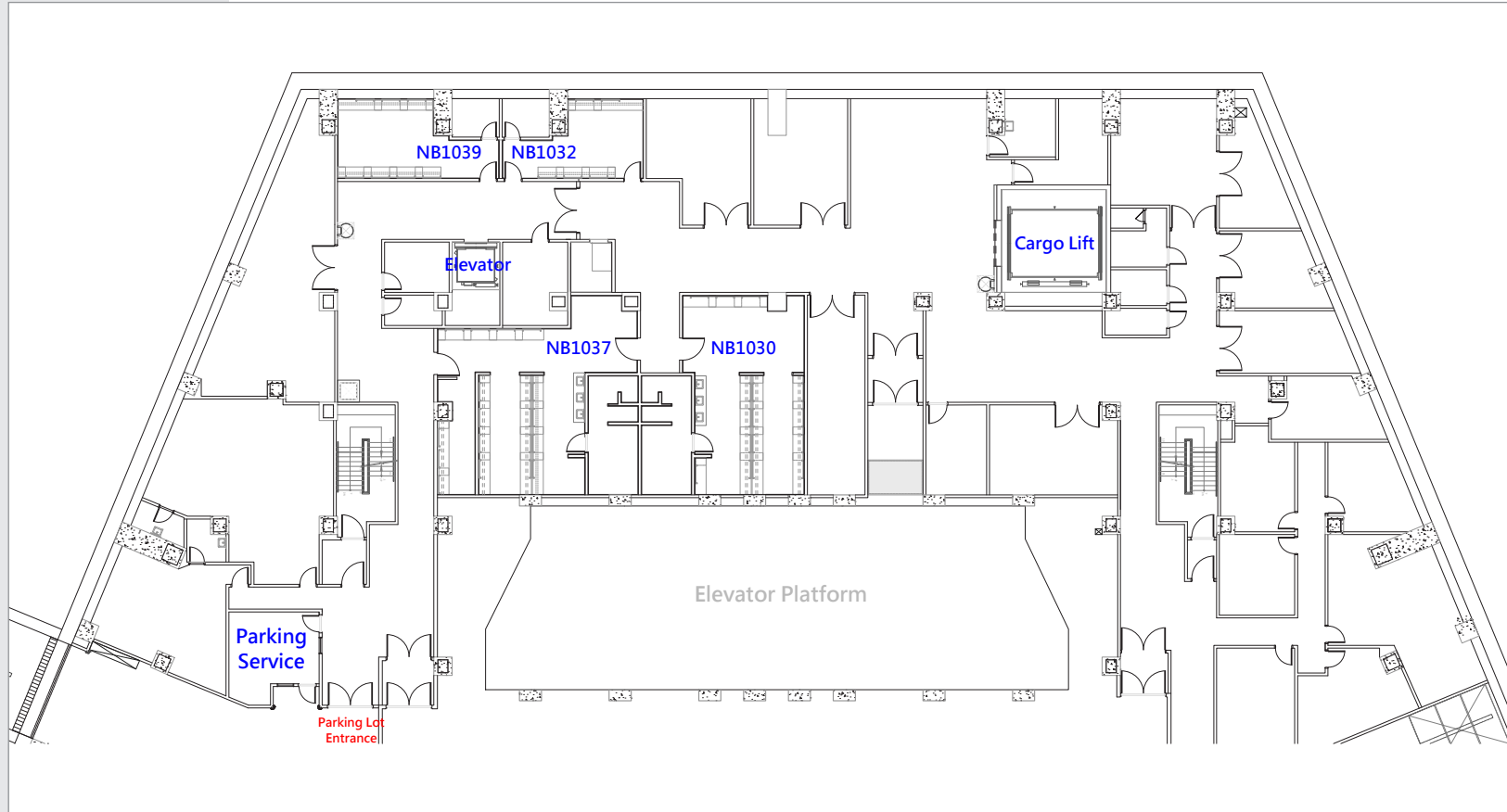

▲ B1 backstage and dressing rooms



Backstage Inventory

No.	Item	Qty
1	NBA folding chair W50*L50*H87cm	1300
2	Folding chair W46*L52*H77cm	1000
3	Folding table L180*W45*H74cm	25
4	Folding table L180*W60*H74cm	5
5	Folding table L76*W49cm	30
6	Signage stand L68*W56*H155cm	10
7	55" TV	3
8	Stanchion H98cm (telescopic belt 200cm)	100

- Organizers can apply in advance according to their needs. Items should be return to the venue after used.

APPENDIX

- Appendix I Full Floorplan
- Appendix II Stage Floorplan
- Appendix III Stage Elevation Floorplan
- Appendix IV Stage Side View Floorplan
- Appendix V Rigging Points Floorplan
- Appendix VI Lighting Floorplan

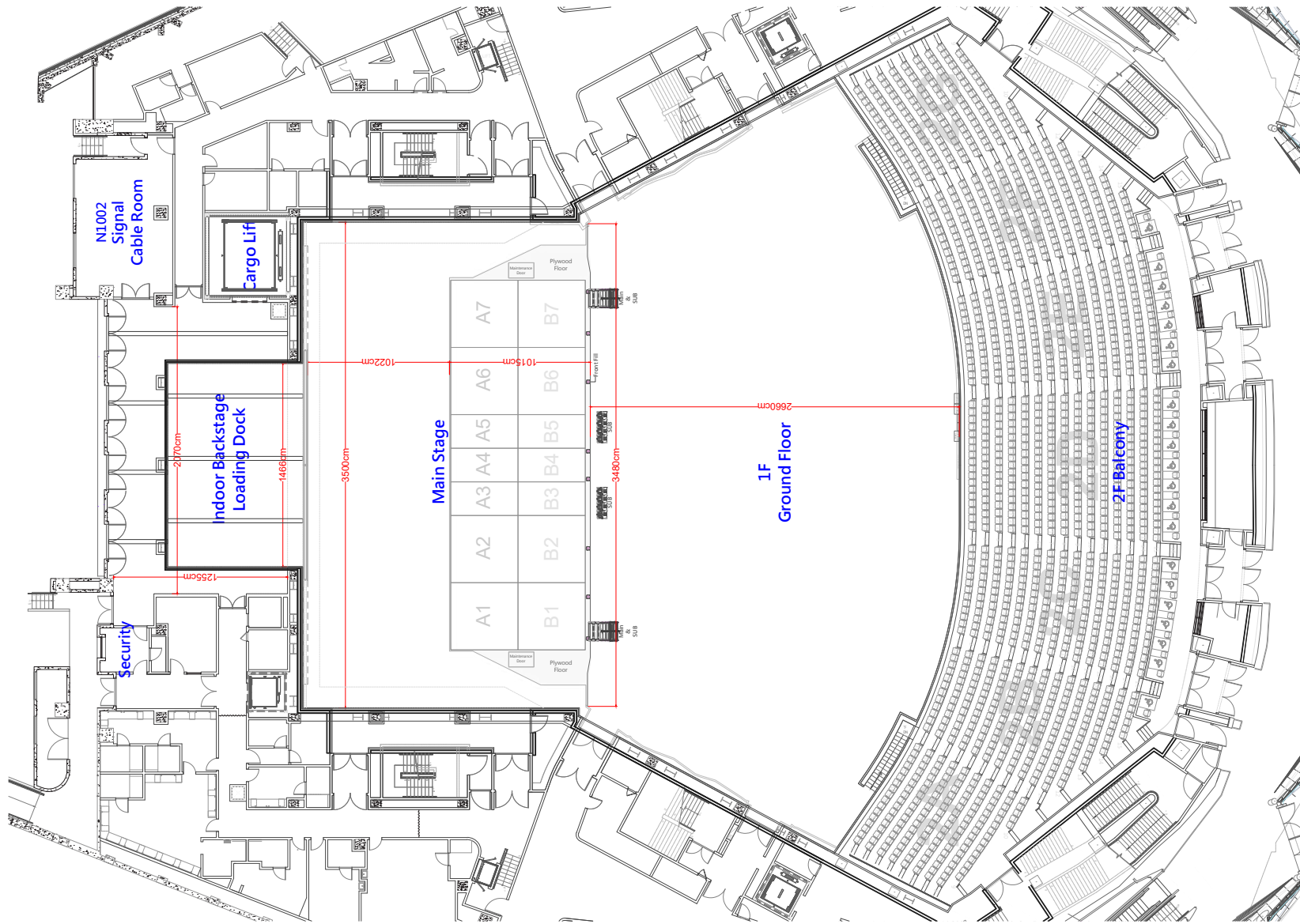

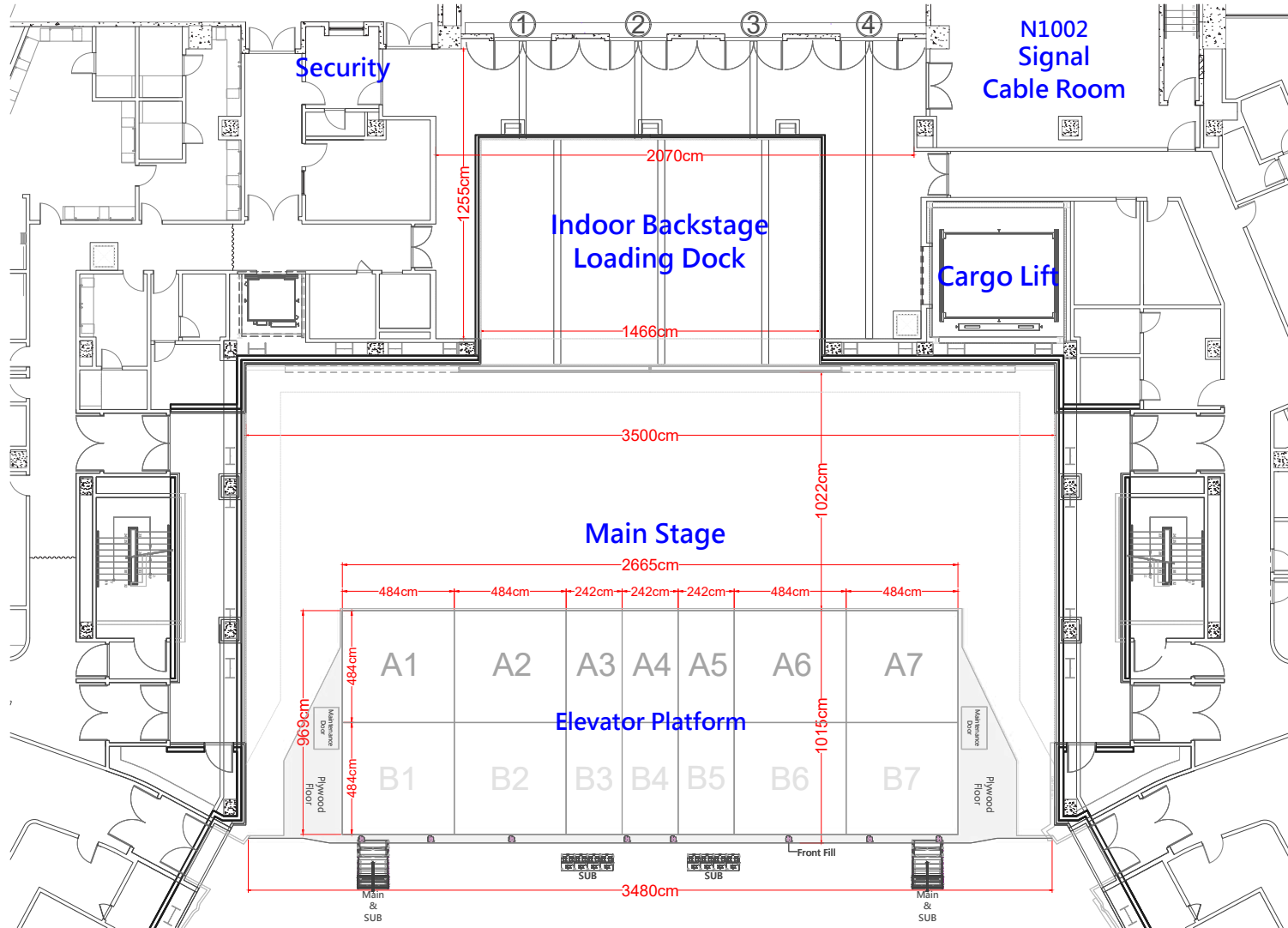

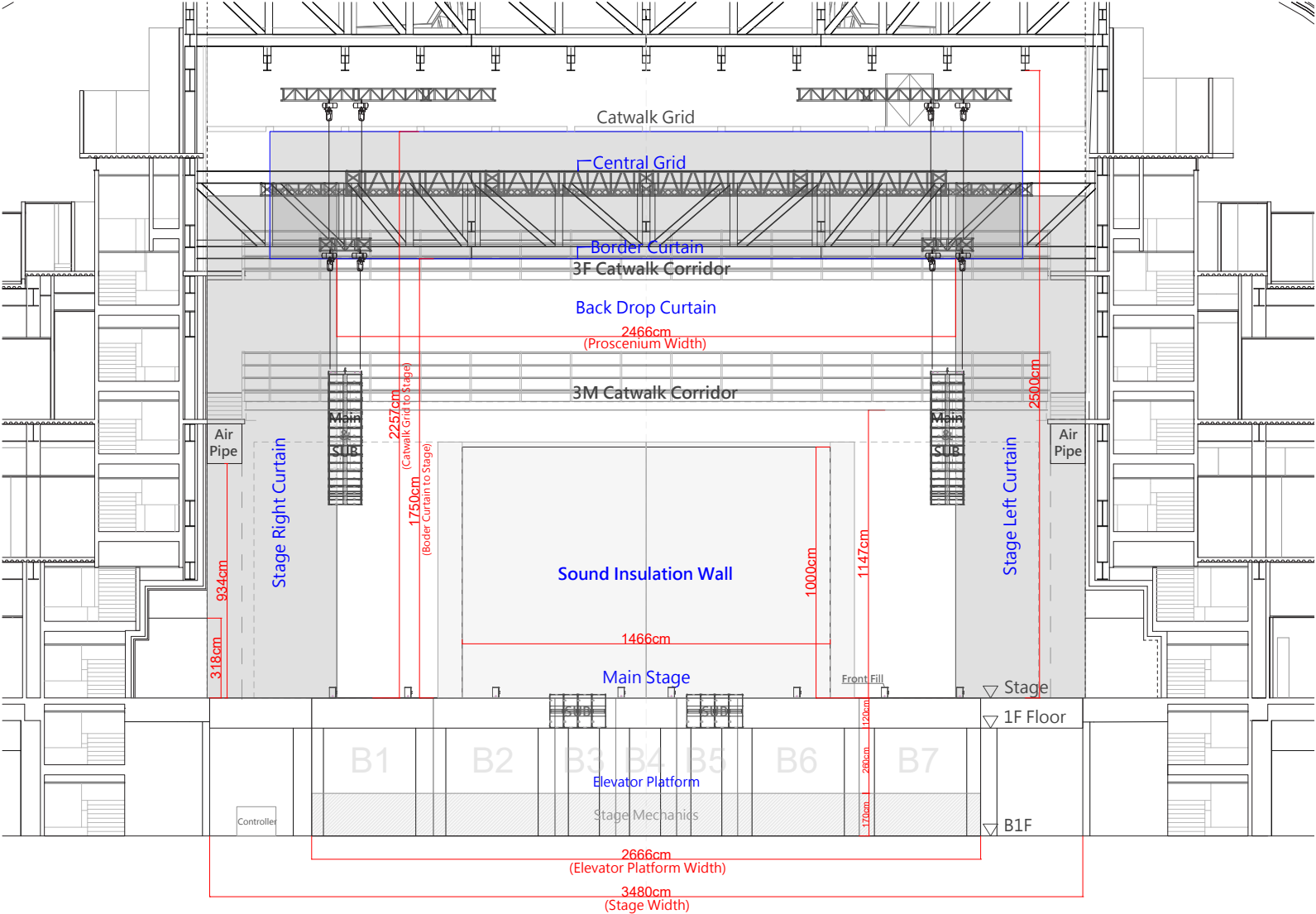

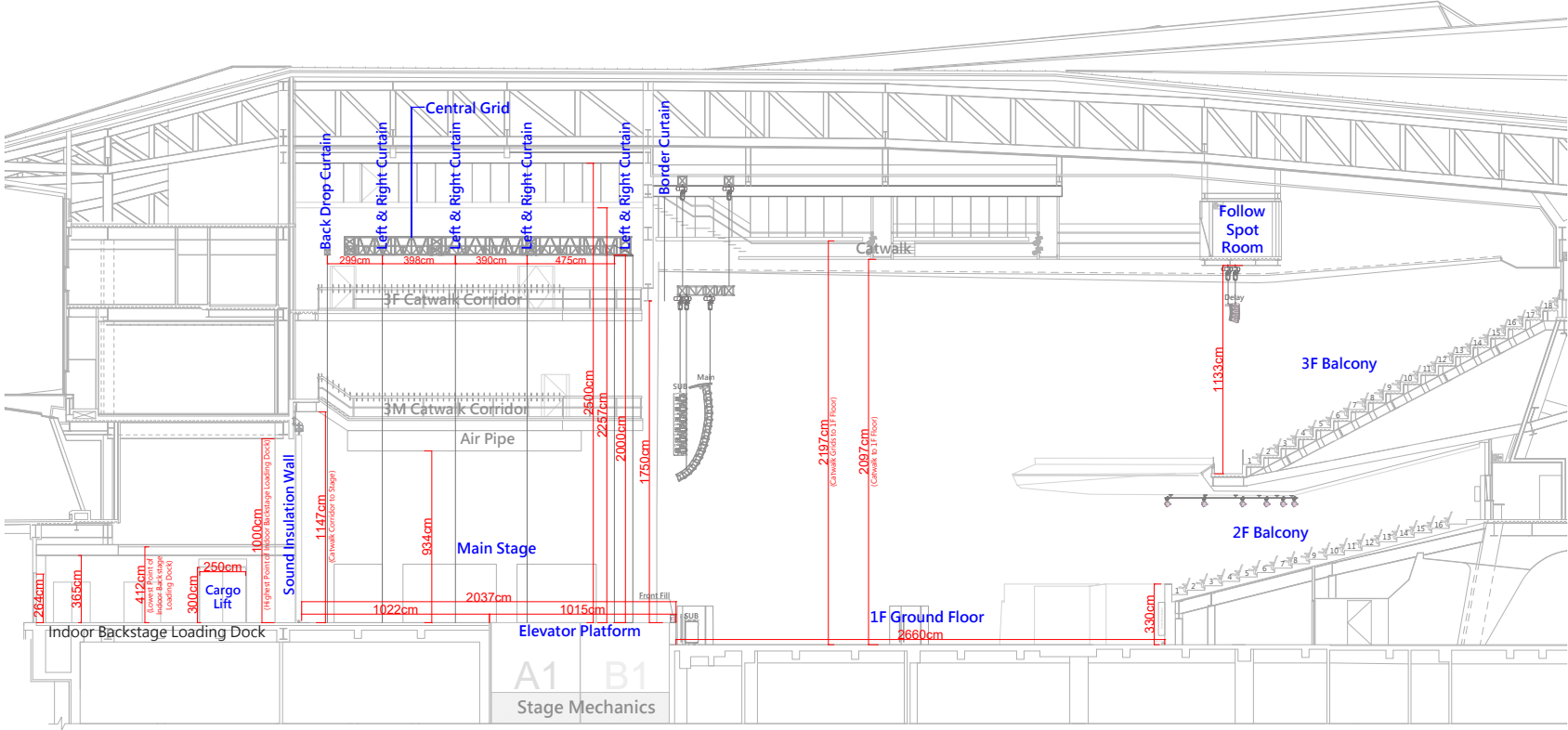

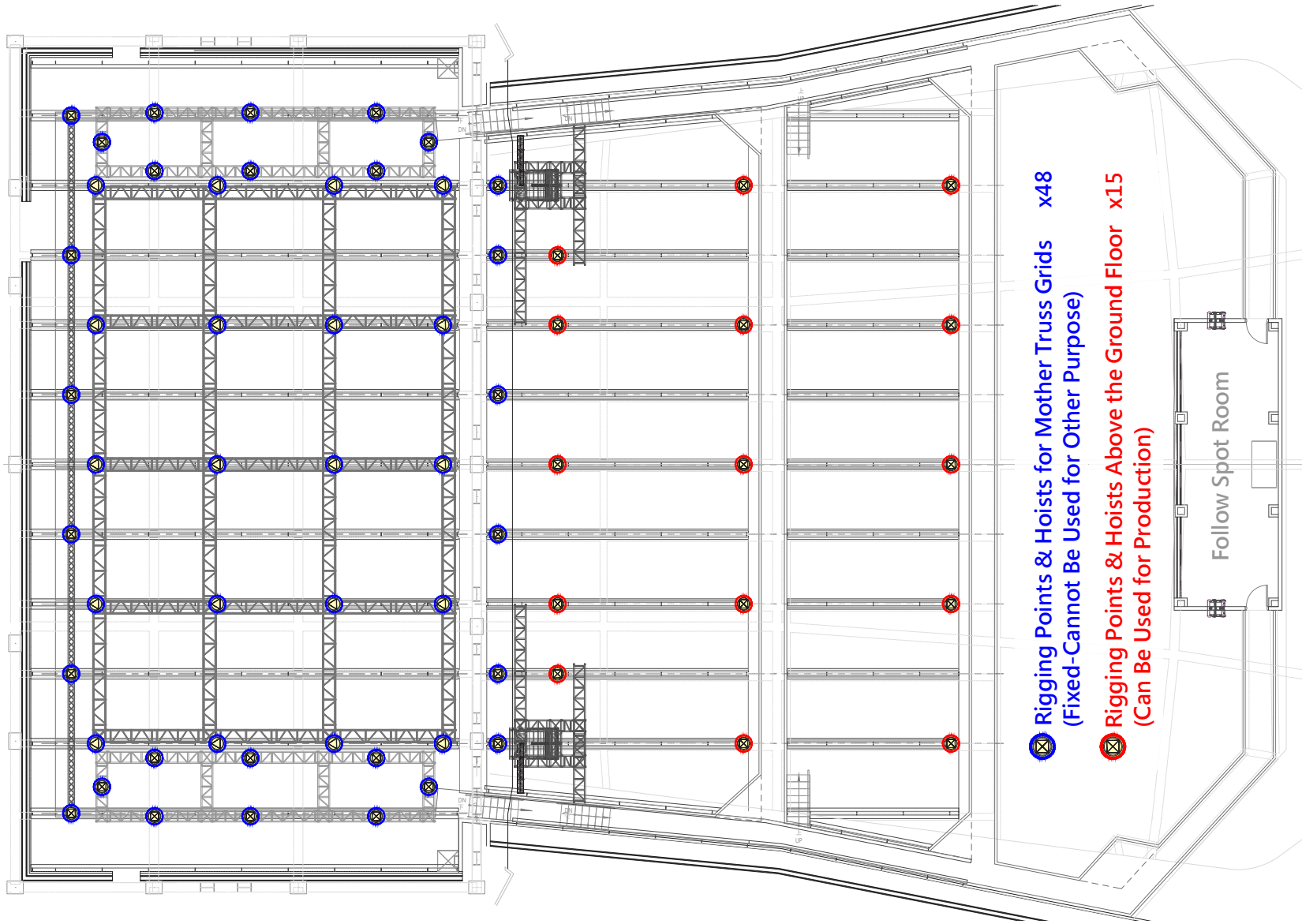



ACME TS-300 **x16**
@3M Catwalk Corridor Above the Main Stage

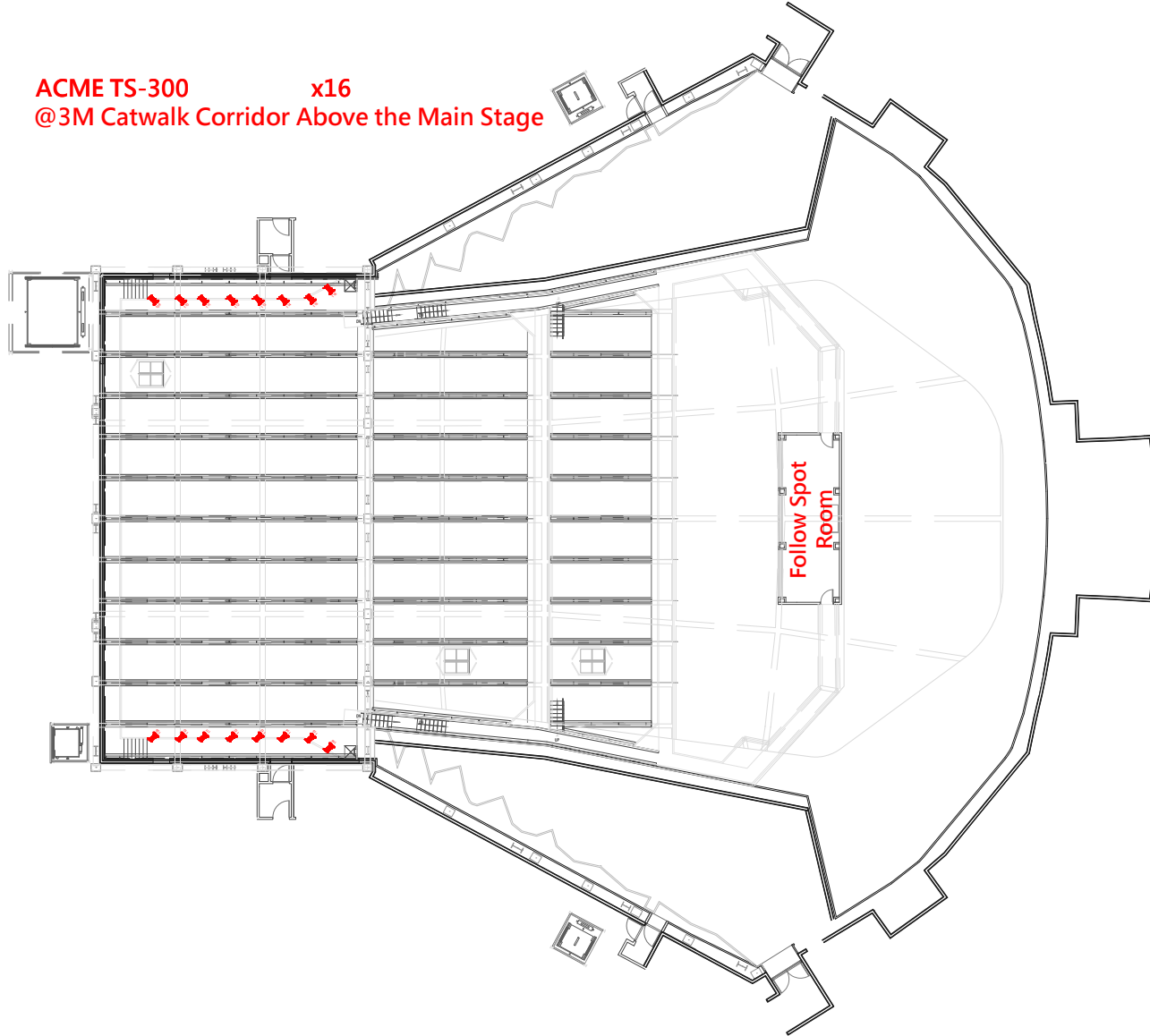

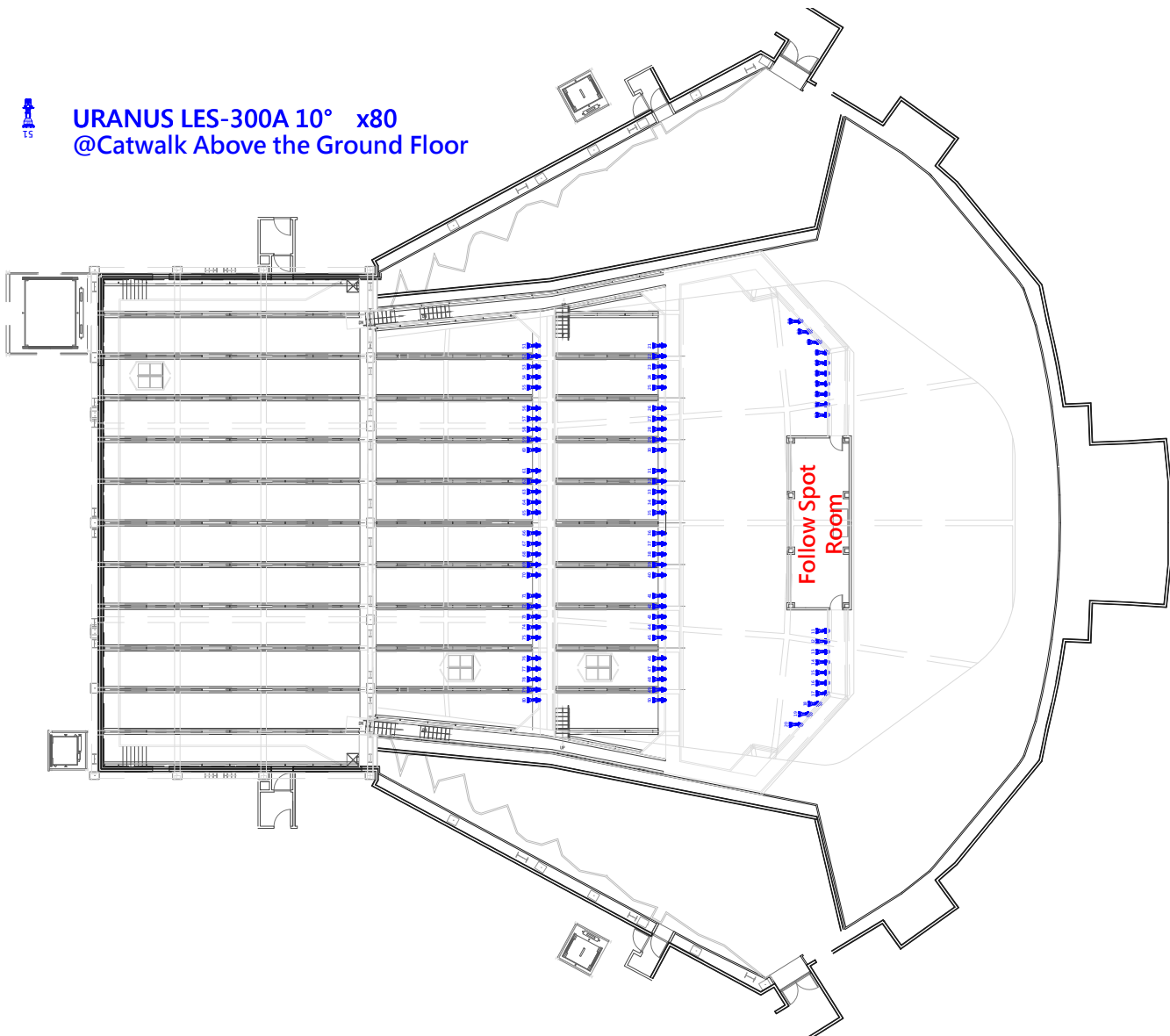





臺北流行音樂中心 Taipei Music Center

 musiccenter.taipei

 +886-02-2788-6620

 info@tmc.taipei

 臺北流行音樂中心 Taipei Music Center

115028 臺北市南港區市民大道八段 99 號
No.99, Section 8, Civic Blvd., Nangang Dist., Taipei
City 115, Taiwan

Version: 2020.12